

CLEMONS

SALES CORPORATION

**Manufacturers and Distributors
of Irrigation, Filtration, and
Industrial Equipment**

- Bubbler Tops
- Butterfly Valves
- Clearwater and Sturgeon Self Cleaning Suction Screens
- Cones (Concentric & Eccentric)
- Custom Fabrication & Equipment
- Elbows – Tees – Y's – Z-Drops and Manifolds
- Flanges – Victaulic & Ringlock Fittings
- Gaskets (Flange & Coupler)
- Pressure Filters (Pivot)
- Saddles
- Sand Separators
- S.S. Line Strainers
- S.S. Screen (Perforated & Mesh)
- Steel Pipe
- Threaded Couplers & Nipples
- Valves (Check – Foot – Gate & Ball)
- Water Tight & Compression Couplers

6983 Supply Way • Boise, Idaho 83716 • (208) 345-2525

Toll Free 1-800-635-5975

FAX 1-208-345-2143

www.clemonssales.net

e-mail contacts: purchasing@clemonssales.net

Rick – sales@clemonssales.net

Dave – dave@clemonssales.net

Brian – info@clemonssales.net

Dick – dick@clemonssales.net

2018 CATALOG



Manufacturers and Distributors of Irrigation and Industrial Equipment
6983 Supply Way • Boise, Idaho 83716
(208) 345-2525 / Toll Free 1-800-635-5975
FAX 1-208-345-2143
[www. clemonssales.net](http://www.clemonssales.net)
e-mail purchasing@clemonssales.net

TABLE OF CONTENTS

CATALOG ITEMS	PAGE
1/2" Plate Flanges, Ring and Full Faced Gaskets.....	2
Class D Flanges, Plated Bolts and Nuts	3
Butterfly Bolts, BNnG Sets.....	4
Cones, Elbows, Tees, Wyes, Z Drops.....	5-9
Clemons Pressure Filters.....	10-14
Pressure Gauges, Pressure Filter Accessories.....	12
Sturgeon Self-Cleaning Suction Screens, Bubblers.....	15
Clearwater Self-Cleaning Suction Screens.....	16
Wide Wand Clearwater Suction Screen	17
Clearwater Suction Parts List	18
Screen, Line Strainers, Hwy. Guards, Basket Strainers	19-20
Clemons Centrifugal Sand Separators	21
Enbee Butterfly Valves.....	22
Enbee Double Door Check Valves	23
Check, Chemigation & Foot Valves	24-26
Check, Chemigation, and Foot Valve Parts	27
Stainless Steel Check & Foot Valves	28
Gate, Ball, Straight Line Valves, Electric Timers & Surge Relief Valves	29-30
Air Relief Valves, Ring Lock Fittings & Hose Adaptors.....	31
Water Tight, Compression Epoxy Fittings	32-33
Parts List for Compression & Water Tight Couplers	34
Black Steel Nipples, Couplings.....	34
Tank Domes, Victaulic Fittings	35
Saddles, Valve Tops.....	36
Flanged Elbows, Tees & Spools.....	37
Steel Pipe	38
Clemons Pressure Filter Operation & Maintenance Instructions	39
Clearwater Self-Cleaning Suction Screens Installation & Operating Instructions	40-41
Sand Separator Installation and Operating Instructions. Separator Dimensions	42-44
Warranty Disclaimer.....	45
Clemons Sand Separator Automatic Purge Valve Timer	46-47

Manufacturers and Distributors of Irrigation and Industrial Equipment
 6983 Supply Way • Boise, Idaho 83716
 (208) 345-2525 / Toll Free 1-800-635-5975
 FAX 1-208-345-2143
www.clemonssales.net
 e-mail purchasing@clemonssales.net



FLANGES – GASKETS

STEEL FLANGES



*1/2", 5/8" Thick Flanges are Machined & Drilled
 *AWWA Class D Flanges, page 3 in Catalog

No. 2105

O.D. - Outside Diameter
 I.D. - Inside diameter
 B.C. - Diameter of Bolt Circle
 N.H. - Number of Holes
 H.S. - Hole Size
 B.S. - Bolt Size

SIZE	I.D.	O.D.	B.C.	N.H.	H.S.	B.S.	Flange Wt.	Flange Thickness
2		6	4.75	4	3/4	5/8	4	1/2"
2 1/2		7	5.5	4	3/4	5/8	4	1/2"
3-3 1/2		7.5	6	4	3/4	5/8	5	1/2"
4-4 1/2		9	7.5	8	3/4	5/8	6	1/2"
5-5.6		10	8.5	8	7/8	3/4	7	1/2"
6-6.7		11	9.5	8	7/8	3/4	8.5	1/2"
8-8.7		13.5	11.75	8	7/8	3/4	12	1/2"
10-10.8		16	14.25	12	1	7/8	15	1/2"
12-12.8		19	17	12	1	7/8	22	1/2"
14		21	18.75	12	1 1/8	1	32	5/8"
16		23.5	21.25	16	1 1/8	1	38	5/8"
18		25.0	22.75	16	1 1/4	1 1/8	40	5/8"
20		27.5	25	20	1 1/4	1 1/8	49	5/8"
22		29.5	27.25	20	1 1/4	1 1/8	58	5/8"
24		32	29.5	20	1 3/8	1 1/4	67	5/8"

Red Rubber

Non Asbestos

SIZE	NO. 2106-R	NO. 2106-F
2		
2.5		
3		
4		
5		
6		
8		
10		
12		
14		
16		
18		
20		
24		

SIZE	NO. 2107-R	NO. 2107-F
2		
2.5		
3		
4		
5		
6		
8		
10		
12		
14		
16		
18		
20		
24		

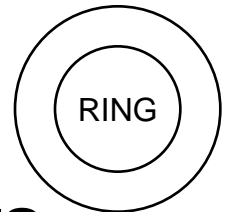

GASKETS

(1/16" thick)
 (1/8" available)

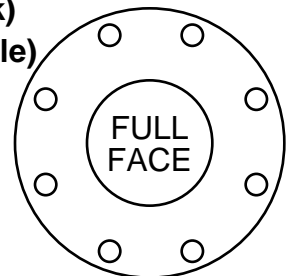

Manufacturers and Distributors of Irrigation and Industrial Equipment
 6983 Supply Way • Boise, Idaho 83716
 (208) 345-2525 / Toll Free 1-800-635-5975
 FAX 1-208-345-2143
 www.clemonssales.net
 e-mail purchasing@clemonssales.net

AWWA CLASS D FLANGES BOLTS & NUTS

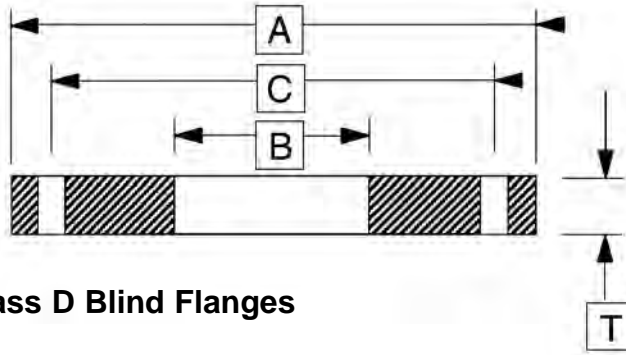

For Class D Blind Flanges

No. 2108

AWWA Class "D" Steel Flanges

NOM. SIZE	"A" O.D.	"T" THICKNESS	"B" BORE	NO. OF BOLT HOLES	DIA. OF BOLT HOLES	"C" BOLT CIRCLE	WEIGHT
4"	9"	5/8"	4.57"	8	3/4"	7-1/2"	7.8
4"	9"	5/8"	4-1/16"	8	3/4"	7-1/2"	7.8
5"	10"	5/8"	5.66"	8	7/8"	8-1/2"	9.0
5"	10"	5/8"	5-1/16"	8	7/8"	8-1/2"	9.0
6"	11"	11/16"	6.72"	8	7/8"	9-1/2"	10.0
6"	11"	11/16"	6-1/16"	8	7/8"	9-1/2"	10.0
8"	13-1/2"	11/16"	8.72"	8	7/8"	11-3/4"	15.0
8"	13-1/2"	11/16"	8-1/16"	8	7/8"	11-3/4"	15.0
10"	16"	11/16"	10.88"	12	1"	14-1/4"	22.0
10"	16"	11/16"	10-1/16"	12	1"	14-1/4"	22.0
12"	19"	13/16"	12.88"	12	1"	17	36.0
12"	19"	13/16"	12-1/16"	12	1"	17	36.0
14"	21"	15/16"	14.13"	12	1-1/8"	18-3/4"	48.0
16"	23-1/2"	1"	16.13"	16	1-1/8"	21-1/4"	63.0
18"	25"	1-1/16"	18.13"	16	1-1/4"	22-3/4"	65.0
20"	27-1/2"	1-1/8"	20.13"	20	1-1/4"	25"	85.0
24"	32"	1-1/4"	24.13"	20	1-3/8"	29-1/2"	105.0
30"	38-3/4"	1-3/8"	30.13"	28	1-3/8"	36"	170.0
36"	46"	1-5/8"	36.19"	32	1-5/8"	42-3/4"	265.0
48"	59-1/2"	1-3/4"	48.19"	44	1-3/4"	56"	428.0

No. 4035

Plated Bolts and Nuts

BOLTS

- 5/8 x 2 NC GR 2 CAP SCR. Pin
- 5/8 x 4 NC GR 2 CAP SCR. Pin
- 3/4 x 2 NC GR 2 CAP SCR. Pin
- 3/4 x 4-1/2 NC GR 2 CAP SCR. Pin
- 7/8 x 2 NC GR 2 CAP SCR. Pin
- 7/8 x 5 NC GR 2 CAP SCR. Pin

NUTS

- 5/8 Fin Hex Nut Plain
- 3/4 Fin Hex Nut Plain
- 7/8 Fin Hex Nut Plain

Manufacturers and Distributors of Irrigation and Industrial Equipment
 6983 Supply Way • Boise, Idaho 83716
 (208) 345-2525 / Toll Free 1-800-635-5975
 FAX 1-208-345-2143
 www.clemonssales.net
 e-mail purchasing@clemonssales.net



BNnG SETS 150 lb.

- A complete set of Bolts, Nuts and Gaskets packaged individually for each size upon request.
- Standard BNnG set includes a 1/16" compressed asbestos ring gasket with the correct amount and size of grade 2 bolts and heavy hex nuts.
- Simplifies quoting, purchasing, warehousing and accounting procedures.
- Heavy polyethylene heat-sealed bag through 12" size stands up to rough handling. Boxed in larger sizes.
- Eliminates Gasket and Bolting inventory problems.
- Easy storing – practically eliminates handling costs. A grommet on each set for easy display and handy storage is available.
- Special types in various thickness.

No. 2115



1/16" RING

SIZE	WEIGHT
2	1.5
3	1.5
4	3
5	5
6	5
8	5
10	10
12	11
14	14
16	19
18	25
20	32

No. 2120



1/16" FULL FACE

SIZE	WEIGHT
2	2
3	2
4	3
5	5
6	6
8	6
10	12
12	13
14	15
16	20
18	26
20	33

No. 2125



Butterfly Type – Long Irrigation Set

SIZE	WEIGHT	SIZE	WEIGHT
2	2	6	7
3	2	8	7
4	4	10	16
5	7	12	16

Bolt Lengths are for 1/2" Thick Flanges

No. 2126



Enbee Check Valve Type – Long Irrigation Set

Includes two non asbestos ring gaskets

SIZE	WEIGHT	SIZE	WEIGHT
2	2	6	7
3	2	8	7
4	4	10	16
5	7	12	16

Bolt Lengths are for 1/2" Thick Flanges



Manufacturers and Distributors of Irrigation and Industrial Equipment
 6983 Supply Way • Boise, Idaho 83716
 (208) 345-2525 / Toll Free 1-800-635-5975
 FAX 1-208-345-2143
 www.clemonssales.net
 e-mail purchasing@clemonssales.net

STEEL CONES

Made In USA

SIZE	LGTH.	10 GAGE	WT.	12 GAGE	WT.
2 x 3	2.40	10	.7	NA	NA
2 x 4	3.0	10	1.2	NA	NA
2 x 5	6.0	10	2.7	NA	NA
3 x 4	3.0	10	1.0	12	1.0
3 x 5	3.0	10	1.8	12	1.0
3 x 6	6.0	10	2.5	12	2.2
4 x 5	3.0	10	1.5	12	1.0
4 x 6	3.0	10	1.5	12	1.2
4 x 8	6.0	10	3.5	12	2.5
5 x 6	3.0	10	2.0	12	1.0
5 x 8	6.0	10	4.0	12	2.5
6 x 7	3.0	10	2.0	12	2.0
6 x 8	3.0	10	2.0	12	1.5
6 x 10	6.0	10	5.0	12	3.5
7 x 8	3.0	10	3.0	12	2.0
8 x 10	3.0	10	3.0	12	2.0
8 x 12	6.0	10	7.0	12	5.0
8 x 14	9.0	10	10.0	12	6.0
10 x 12	3.0	10	4.0	12	3.0
10 x 14	6.0	10	9.0	12	8.5
12 x 14	3.0	10	5.0	12	3.5
12 x 16	6.0	10	11.0		
14 x 16	3.0	10	6.0		
16 x 18	3.0	10	7.0		
18 x 20	3.0	10	7.5		
18 x 24	9.0	10	24.9		
20 x 22	3.0	10	8.3		
20 x 24	6.0	10	17.4		
22 x 24	3.0	10	9.1		

Steel CONES

No. 2012 (12 GA)

No. 2010 (10 GA)

10 GA to 3/16

10 GA to 1/4

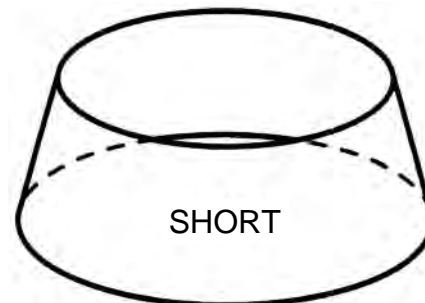

Fittings Welded
Special Coating

SIZE	LGTH.	10 GAGE	WT.	12 GAGE	WT.
2 x 3	5	10		12	.7
2 x 4	6	10		12	.7
2 x 5	6	10		12	1.0
3 x 4	6	10	1.3	12	1.0
3 x 5	6	10	1.6	12	1.3
3 x 6	6	10	1.9	12	1.5
4 x 5	6	10	2.0	12	1.9
4 x 6	6	10	2.5	12	2.2
4 x 8	8	10	3.0	12	2.5
5 x 6	6	10	3.2	12	2.5
5 x 8	8	10	4.4	12	3.5
5 x 10	12	10	6.4	12	5.0
6 x 8	8	10	6.4	12	5.0
6 x 10	12	10	7.6	12	6.0
6 x 12	12	10	10.2	12	9.0
8 x 10	10	10	7.6	12	6.0
8 x 12	12	10	9.0	12	7.6
8 x 14	12	10	10.0		
10 x 12	12	10	8.0		
10 x 14	12	10	10.0		
10 x 16	12	10	14.0		
12 x 14	12	10	11.0		
12 x 16	12	10	14.0		
12 x 18	12	10	18.0		
14 x 16	12	10	14.0		
16 x 18	12	10	16.0		

Eccentric CONES

No. 2112 (12 Ga.)

No. 2110 (10 Ga.)

10 GA to 3/16

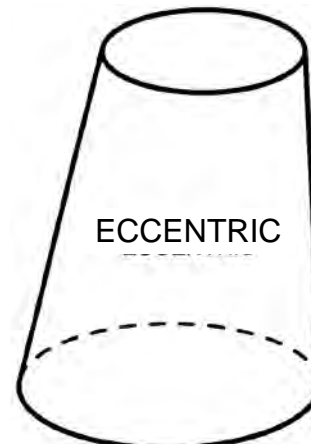

1/4" Wall and Heavier Cones Avail.
Call for Quotations.
IPS Sizes

Manufacturers and Distributors of Irrigation and Industrial Equipment
6983 Supply Way • Boise, Idaho 83716
(208) 345-2525 / Toll Free 1-800-635-5975
FAX 1-208-345-2143
www.clemonssales.net
e-mail purchasing@clemonssales.net



Made In USA

STEEL CONES

Dresser CONES

No. 2135

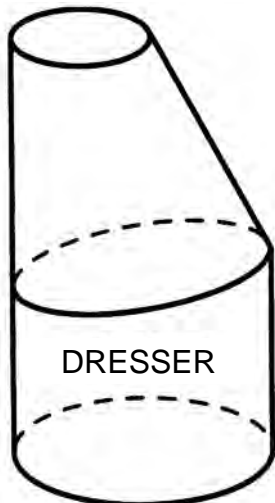

Fittings Welded
Special Coatings

12 GA to 10 GA

SIZE	GAGE	WT.
2 x 3	12	2.0
2 x 4	12	2.0
2 x 5	12	3.0
2.5 x 4	12	2.0
3 x 4	12	2.5
3 x 5	12	3.4
3 x 6	12	4.0
4 x 5	12	3.6
4 x 6	12	4.0
4 x 8	12	6.5
5 x 6	12	5.0
5 x 8	12	8.0
5 x 10	12	11.0
6 x 8	12	9.5
6 x 10	12	11.0
6 x 12	12	14.0
8 x 10	12	12.0
8 x 12	12	13.0
8 x 14	10	17.0
10 x 12	10	14.0
10 x 14	10	17.0

Long CONES

No. 2140

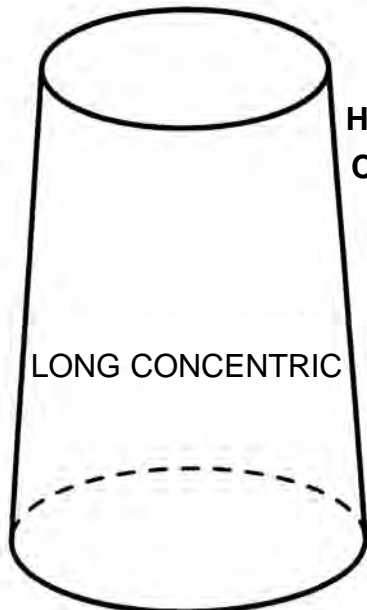

12 GA to 10GA

1/4" Wall and
Heavier Cones Avail.
Call For Quotations.
IPS Sizes

SIZE	GAGE	LENGTH	WT.
2 x 3	12	6"	.7
2 x 4	12	6"	.7
2 x 6	12	6"	1.3
3 x 4	12	6"	1.0
3 x 5	12	6"	1.3
3 x 6	12	6"	1.5
3 x 8	12	12"	5.0
4 x 5	12	6"	2.0
4 x 6	12	6"	2.5
4 x 8	12	8"	3.0
4 x 10	12	12"	6.0
5 x 6	12	6"	2.5
5 x 8	12	8"	3.5
5 x 10	12	12"	5.0
6 x 8	12	8"	5.0
6 x 10	12	12"	6.0
6 x 12	12	12"	9.0
8 x 10	12	12"	6.0
8 x 12	12	12"	9.0
8 x 14	10	12"	10.0
10 x 12	10	12"	9.0
10 x 14	10	12"	10.0
10 x 16	10	12"	14.0
12 x 14	10	12"	11.0
12 x 16	10	12"	14.0
14 x 16	10	12"	14.0
14 x 18	10	12"	15.0
16 x 18	10	12"	16.0
16 x 20	10	12"	16.0
18 x 20	10	12"	17.0

12 GA to 10 GA

Larger Cones Available



Manufacturers and Distributors of Irrigation and Industrial Equipment
6983 Supply Way • Boise, Idaho 83716
(208) 345-2525 / Toll Free 1-800-635-5975
FAX 1-208-345-2143
www.clemonssales.net
e-mail purchasing@clemonssales.net

Made In USA

STEEL ELBOWS – TEES

Call Us for Prices
On Larger Sizes Or
Heavier Wall Thickness

Regular PIPE FITTINGS

No. 2145 (12 GA)
No. 2146 (10 GA)

SIZE	A	B	C	D	10 GAGE	WT.	12 GAGE	WT.
3	7.2	4.5	2	6	10	6.4	NA	NA
4	7.6	5.3	2	6	10	9.6	12	7.5
5	8.0	6.1	2	6	10	12.2	12	9.5
6	8.5	7.0	2	6	10	17.9	12	14.0
6.6	8.7	7.5	2	6	10	19.2	12	15.0
8	9.3	8.6	2	6	10	22.4	12	17.5
8.6	9.5	9.1	2	6	10	24.32	12	19.0
10	10.1	10.3	2	6	10	29.4	12	23.0
10.7	10.5	10.9	2	6	10	32.0	12	25.0
12	11.0	12.0	2	6	10	37.0	12	30.0
12.7	11.3	12.6	2	6	10	39.0	12	32.0
14	11.8	13.6	2	6	10	44.0	12	38.0
16	12.6	15.3	2	6	10	53.0		
18	13.5	16.9	2	6	1/4 Wall	119.0		

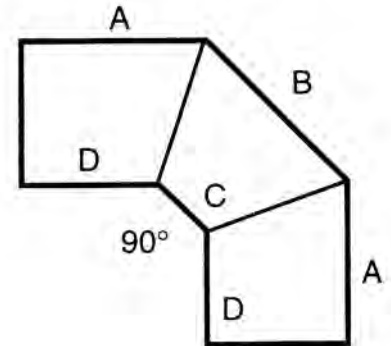

SIZE	A	B	10 GAGE	WT.	12 GAGE	WT.
3	7.2	6	10	5.2	NA	NA
4	7.6	6	10	7.0	12	5.5
5	8.0	6	10	9.0	12	7.0
6	8.5	6	10	12.8	12	10.0
6.6	8.7	6	10	14.0	12	11.0
8	9.3	6	10	17.3	12	13.5
8.6	9.5	6	10	18.0	12	14.0
10	10.1	6	10	19.2	12	15.0
10.7	10.5	6	10	21.8	12	17.0
12	11.0	6	10	25.0	12	20.0
12.7	11.3	6	10	28.0	12	23.0
14	11.8	6	10	33.0	12	24.0
16	12.6	6	10	42.0		
18	13.5	6	1/4 Wall	81.0		

No. 2150 (12 GA)
No. 2151 (10 GA)

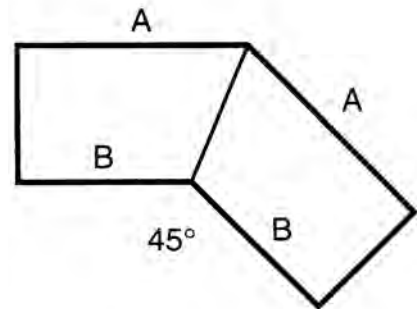

SIZE	A	B	C	10 GAGE	WT.	12 GAGE	WT.
3	15.0	6	6	10	7.7	NA	NA
4	16.6	6	6	10	11.5	12	9.0
5	17.0	6	6	10	15.4	12	12.0
6	18.0	6	6	10	18.0	12	14.0
6.6	18.6	6	6	10	20.5	12	16.0
8	20.0	6	6	10	25.6	12	20.0
8.6	20.6	6	6	10	28.2	12	22.0
10	22.0	6	6	10	33.0	12	26.0
10.7	22.8	6	6	10	37.0	12	29.0
12	24.0	6	6	10	43.0	12	33.0
12.7	24.8	6	6	10	47.0	12	35.0
14	26.0	6	6	10	53.0	12	47.0
16	28.0	6	6	10	64.0		
18	30.0	6	6	1/4 Wall	180.0		

No. 2155 (12 GA)
No. 2156 (10 GA)

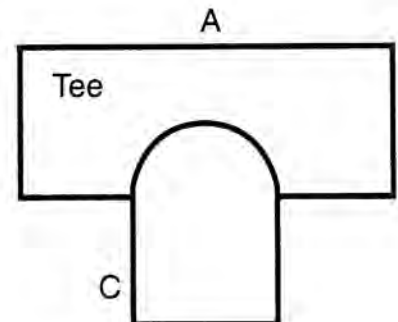

Lateral Wyes
Crosses
to Straight Tee Price

Manufacturers and Distributors of Irrigation and Industrial Equipment
6983 Supply Way • Boise, Idaho 83716
(208) 345-2525 / Toll Free 1-800-635-5975
FAX 1-208-345-2143
www.clemonssales.net
e-mail purchasing@clemonssales.net

 **CLEMONS**
SALES CORPORATION

Made In USA

TEES – GOOSENECKS

Call Us For
Prices On Larger
Sizes Or Heavier
Wall Thickness

Wye Tees 10 GA

SIZE	GAGE	A	B	C	D	E	WEIGHT
4	10	6	8	6	35.0	15.3	30.0
5	10	6	8	6	37.1	16.2	38.0
6	10	6	8	6	41.0	17.2	51.0
6.6	10	6	8	6	42.7	17.8	56.0
8	10	6	8	6	46.5	19.0	75.0
8.6	10	6	8	6	48.0	19.5	85.0
10	10	6	8	6	52.0	20.8	104.0
10.7	10	6	8	6	54.0	21.5	120.0
12	10	6	8	6	57.0	22.6	140.0
12.7	10	6	8	6	59.8	23.3	156.0
14	10	6	8	6	64.0	24.4	172.0
16	10	6	8	6	69.0	26.3	210.0
18	1/4 Wall	6	8	6	74.0	28.2	564.0

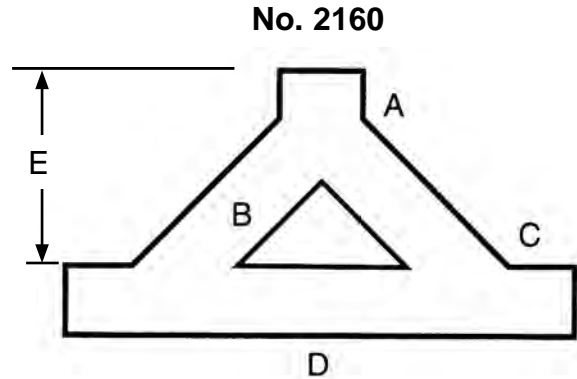

Wyes

SIZE	GAGE	WEIGHT
4	12	8
5	12	10
6	12	12
6.6	12	15
8	12	15
8.6	12	20
10	12	23
10.7	12	26
12	12	28
12	10	39
12.7	12	31
12.7	10	43
14	10	48
16	10	59
18	1/4 Wall	117

No. 2165
12 GA to 10 GA

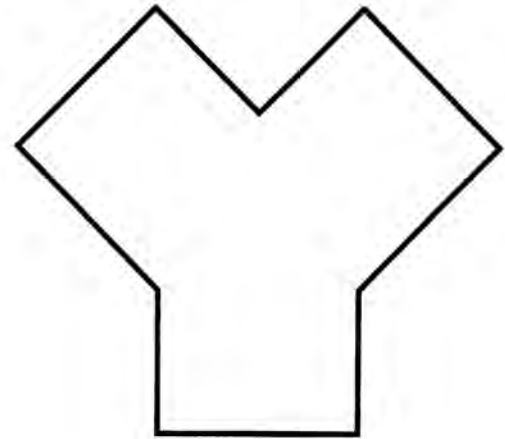

Bare End Z Drops – 10 GA – 33” Vertical Centers

Z Drops Can Be Custom Made To Your Specifications

STYLE A

STYLE B

SIZE	GAGE	WEIGHT	WEIGHT
4	10	23	25
5	10	29	32
6	10	35	39
6.6	10	39	43
8	10	48	52
8.6	10	51	56
10	10	60	65
10.7	10	64	71
12	10	93	100
12.7	10	100	109
14	10	115	125
16	10	132	144

No. 2166 (Style A) 10 GA

No. 2167 (Style B) 10 GA

We Will Add Fittings
To Your Specifications
On Any Pipe Fitting

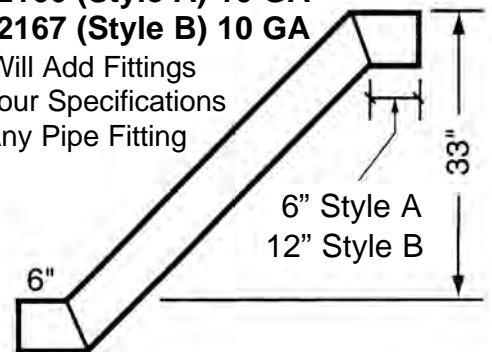

Manufacturers and Distributors of Irrigation and Industrial Equipment
6983 Supply Way • Boise, Idaho 83716
(208) 345-2525 / Toll Free 1-800-635-5975
FAX 1-208-345-2143
www.clemonssales.net
e-mail purchasing@clemonssales.net

STD. WALL WELD ELBOWS – CONES – CAPS

Standard Wall Smooth Long Radius Weld Elbows

No. 2000



45° ELBOWS

No. 2001



90° ELBOWS

SIZE	WALL THICKNESS	WEIGHT
3	.216	2.5
4	.237	4.3
5	.258	8.3
6	.280	11.3
8	.322	22.8
10	.365	42.4
12	.375	60.3
14	.375	80.0
16	.375	101.0
18	.375	128.0

SIZE	WALL THICKNESS	WEIGHT
3	.216	4.7
4	.237	8.7
5	.258	16.0
6	.280	22.8
8	.322	44.9
10	.365	84.0
12	.375	122.0
14	.375	157.0
16	.375	206.0
18	.375	262.0

Standard Wall Concentric – Eccentric Reducers and Weld Caps

No. 2002



CONCENTRIC

No. 2003



ECCENTRIC

No. 2004



CAP

SIZE	WALL THICKNESS	WEIGHT
3x4	.216	3.3
3x6	.237	6.9
4x6	.258	7.4
4x8	.258	10.8
5x8	.258	11.5
6x8	.280	12.3
6x10	.365	20.7
8x10	.365	23.1
8x12	.365	30.5
10x12	.365	32.4
12x14	.375	63.1
12x16	.375	72.7
14x16	.375	75.4
16x18	.375	87.3

SIZE	WALL THICKNESS	WEIGHT
3x4	.216	3.3
3x6	.237	6.9
4x6	.258	7.4
4x8	.258	10.8
5x8	.258	11.5
6x8	.280	12.3
6x10	.365	20.7
8x10	.365	23.1
8x12	.365	30.5
10x12	.365	32.4
12x14	.375	63.1
12x16	.375	72.7
14x16	.375	75.4
16x18	.375	87.3

SIZE	WALL THICKNESS	WEIGHT
3	.216	1.7
4	.237	2.8
5	.258	4.6
6	.280	6.9
8	.322	11.8
10	.365	20.8
12	.375	30.3

For Sizes Not Listed
Call For Pricing

Manufacturers and Distributors of Irrigation and Industrial Equipment
 6983 Supply Way • Boise, Idaho 83716
 (208) 345-2525 / Toll Free 1-800-635-5975
 FAX 1-208-345-2143
 www.clemonssales.net
 e-mail purchasing@clemonssales.net



Made In USA

CLEMONS PRESSURE FINE FILTERS

12 GA - 10 GA - 10 GA High pressure filter body configuration options for all Clemons pressure filter models. We will customize any filter model to your specifications. All filters come standard in 12GA, specify if ordering 10GA. 2000A GPM filters come standard in 10GA. Specify galvanized or enameled filter bodies

All five configurations are available in models 275A, 475A, 700A, 1200A, and 2000A



Bare Standard Down (BSD)
Model BSD



Flanged Standard Down (FSD)
Model FSD



Bare Center Up (BCU)
Model BCU



Flanged Center Up (FCU)
Model FCU



Flanged by Female Ringlock Center Up (FRC)
Model FRC

Customized filters please call. Side outlets and multiple outlets are options.

Pump suction side models available.

High pressure safety bar set for filter models 275A, 475A, 700A, and 1200A. Rated for 125 to 175 P.S.I.

(Screen Size Options Top of Page 11)

MODEL	REPLACE- MENT SCREENS	EXTRA BANDS ON SCREEN FOR HIGH PRESSURE	HIGH PRESSURE BAR SET ONLY 125 TO 175 P.S.I.	STAINLESS SCREEN		STAINLESS SCREEN		SPECIFY (G OR E) G-Galvanized E-Enameled
				12 GA. GALV. BARREL	WITH 12 GA. ENAMELED BARREL	10 GA. GALV. BARREL	WITH 10 GA. ENAMELED BARREL	
275A	More							No. 2170 (G or E)
475A	Options				See Page 11			No. 2175 (G or E)
700A	Next				For 12 GA			No. 2180 (G or E)
1200A	Page				Filter Prices			No. 2185 (G or E)
2000A								No. 2195 (G or E)



Manufacturers and Distributors of Irrigation and Industrial Equipment
6983 Supply Way • Boise, Idaho 83716
(208) 345-2525 / Toll Free 1-800-635-5975
FAX 1-208-345-2143
www.clemonssales.net
e-mail purchasing@clemonssales.net

Made In USA

CLEMONS PRESSURE FINE FILTERS

Operation and Maintenance Instructions pg.39

With Perforated
Stainless
Screen

24 Gage

Stainless Steel Screen

3/64" - .045" Protects pivots and other systems or
3/32" - .094" Protects pivots and other systems (20 & 24 Gage)
2000A Model Filter Available Only In .045" & .094" Perf.

Filters Available In All 304
Stainless Steel Construction
Call for Prices

New 24 Gage Perforated Sizes Available

Call for pricing on these perf sizes.

1/32" - .031" Protects pivots and other systems
3/16" - .188" System protection
1/8" - .125" Coarse system protection
1/4" - .250" Coarse system protection

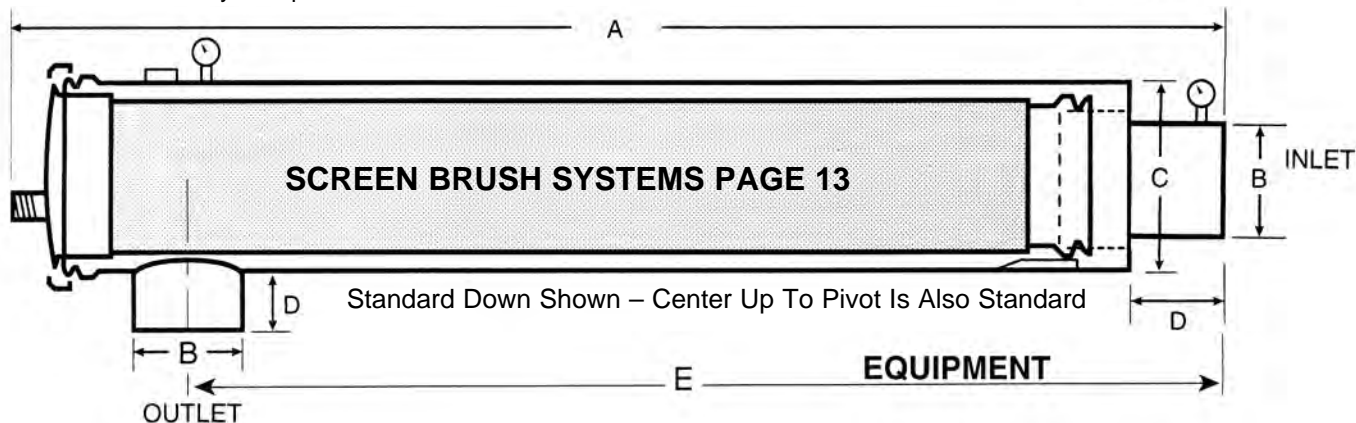

STANDARD EQUIP.

Barrels – Galv. or Enamel
24 GA. S.S. Perf. 3/64" & 3/32"
Ring Band Lock
Replaceable Gaskets
Can Be Welded Into Line

0-125 Working Pressure
Stainless Steel Screens
1/2" Drain with Plug
2" Air Vent Coupler
Self Cleaning Blow Off

OPTIONAL EQUIP.

(2) Pressure Gauges 1/4"
Blow Off Valve (Gate or Ball)
2" Air Vent Valve
Flanged, Ringlock, or Victaulic Ends
Larger Blow Off up to 4"

Outlet In Any Position (Pivot Pad to Pivot)
125 to 175 P.S.I.
Screen Brushes, page 13
Filter Manifolds, page 13
20 GA. S.S. Perf. 3/32" Screen

Add 1/4" To Measurements D & E For Flanged Filters

MODEL	GPM	A	B	C	D	E	Outlet Standard Down	Outlet Center Up	BLOW OFF OUTLET	12 GA. WEIGHT	10 GA. WEIGHT
275A	275	68	4	6 5/8	6	54	35 3/4	1"	70	80	
475A	475	70	6	12	6	53	35 3/4	2"	130	150	
700A	700	77	8	14	6	59	39 1/2	2 1/2"	170	200	
1200A	1200	130.5	8-10	14	6	112	66	2 1/2"	250	298	
2000A	2000	139.8	12	16	6	119 3/4	70 1/2	4	NA	412	

FILTERS & OPTIONS

MODEL No.	2 GAUGES	GATE FLUSH VALVE	REPLACE-MENT SCREENS	EXTRA BANDS ON SCREEN FOR HIGH PRESSURE	HIGH PRESSURE BAR SET ONLY 125 TO 175 P.S.I.	STAINLESS SCREEN WITH		SPECIFY (G OR E) G-Galvanized E-Enameled
						12 GA. GALV. BARREL	12 GA. ENAMELED BARREL	
275A	More	1"						No. 2170 (G or E)
475A	Options	2"						No. 2175 (G or E)
700A	Next	2 1/2"						No. 2180 (G or E)
1200A	Page	2 1/2"						No. 2185 (G or E)
2000A	4							No. 2195 (G or E)

10 GA Pricing Page 10

Manufacturers and Distributors of Irrigation and Industrial Equipment
6983 Supply Way • Boise, Idaho 83716
(208) 345-2525 / Toll Free 1-800-635-5975
FAX 1-208-345-2143
www.clemonssales.net
e-mail purchasing@clemonssales.net



PRESSURE FILTER OPTIONS – GAUGES

Two Flanges Welded To Pressure Filters

MODEL	No. 2005 TWO FLANGES WELDED GALVANIZED		No. 2006 TWO FLANGES WELDED ENAMELED	
		WT		WT
275 - 4" x 1/2"		12		
475 - 6" x 1/2"		17		
700 - 8" x 1/2"		24		
1200 - 10" x 1/2"		30		
2000 - 12" x 1/2"		44		
2000 - 12" Class D		72		

Class D Flanges for 90 and above P.S.I.

Galvanized Filter Screen Ends

MODEL	WT	No. 2007 BLOWOFF HEADS	No. 3025G GALVANIZED FEMALE PUMP STARTER 12 GA		PUMP STARTER GASKET ONLY SIZE #2305
275	7		4"	3"	
475	16		8"	4"	
700	20		10"	5"	
1200	20		10"	6"	
M-150	6		3"	8"	
M-80	6		3"	10"	
2000	56		12"	12"	
				14"	

- 2" Air Relief Valve
- 2" Half Coupler on Galvanized Filter Std. Equipment
- 2" Half Coupler on Enameled Filter Std. Equipment
- 1/2" Drain Coupler on Galvanized Filter Std. Equipment
- 1/2" Drain Coupler on Enameled Filter Std. Equipment
- Complete High Pressure Bar Parts
- (Set for Filter Model 700 and 1200)



Pressure GAUGES

Liquid Filled
Corrosion Proof
1/4" Stem

Specify
0 - 100 P.S.I.
0 - 160 P.S.I.
0 - 200 P.S.I.

BIRCH

SIZE	PART No.	TYPE
2 1/2"	4005	Liquid Filled
2"	4006	Regular



Manufacturers and Distributors of Irrigation and Industrial Equipment
6983 Supply Way • Boise, Idaho 83716
(208) 345-2525 / Toll Free 1-800-635-5975
FAX 1-208-345-2143
www.clemonssales.net
e-mail purchasing@clemonssales.net

Made In USA

FILTER MANIFOLDS AND BRUSHES



No. 2188

Flanged Inlet Manifolds

SIZE	GAGE	WEIGHT
8 x 8 x 8	12	99
8 x 8 x 10	12	122
10 x 10 x 10	12	124
10 x 10 x 12	12	153
12 x 12 x 12	10	192

Galvanized Flanged Inlet and Outlet 700A, 1200A, and 2000 Pressure Filter Manifolds

All wyes are the size of the largest diameter
Discharge wye turns to any position
Ringlock connections available upon request

No. 2189

Flanged Outlet Manifolds

SIZE	GAGE	WEIGHT
8 x 8 x 8	12	58
8 x 8 x 10	12	74
10 x 10 x 10	12	76
10 x 10 x 12	12	100
12 x 12 x 12	10	120



Brush cleaning option – Models 700 through 2000 only.



NEW – cleaning brush stays inside screen. Screen manually cleaned while system is in operation.

No. 2191

Parts List for Filter Brush Components for 700 GPM, 1200 GPM, and 2000 GPM Pressure Filters

DESCRIPTION

- Poly brush for 700A filter with stainless steel handle
- Poly brush for 1200A filter with stainless steel handle
- Replacement poly brush only for 700 and 1200 filters
- Replacement poly brush only for 2000 filters
- Models 700A and 1200A filters with filter brush style blow off, brush comes out, Price does not include brush and handle
- Replacement blow off end only to convert existing filter to filter brush style
- Models 700A and 1200A filters with filter brush style, **brush stays inside filter doesn't come out, handle sticks out,**
- Models 700A and 1200A filters with 8" ringlock brush cap, **brush stays inside filter and handle sticks out.**
- Model 2000A filters with filter brush style, **brush stays inside filter doesn't come out, handle sticks out,**
- Models 700A and 1200A 45 degree inlet filters with 8" bare inlet and outlet. **Both filter brush and handle stay inside the filter while system is operating.**
- Model 1200A 45 degree inlet filters with 10" bare inlet and outlet. **Both filter brush and handle stay inside the filter while system is operating.**
- Model 2000A 45 degree inlet filters with 12" bare inlet and outlet. **Both filter brush and handle stay inside the filter while system is operating.**

Manufacturers and Distributors of Irrigation and Industrial Equipment
6983 Supply Way • Boise, Idaho 83716
(208) 345-2525 / Toll Free 1-800-635-5975
FAX 1-208-345-2143
www.clemonssales.net
e-mail purchasing@clemonssales.net



Made In USA

MINI AND STAINLESS FILTERS

Operation and Maintenance Instructions pg.37

Mini Inline Filters

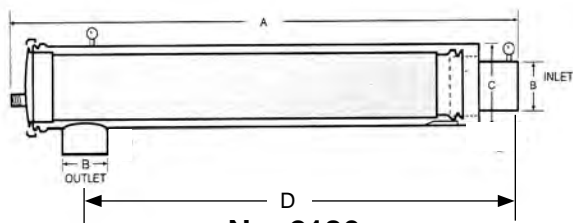

No. 2186

STANDARD

- Barrels – Epoxy
- Ring Band Lock
- Replaceable Gaskets
- 2" and 3" FIPT Connection
- Self-Cleaning Blow Off
- (2) 1/4" Pressure Gauge Parts

OPTIONAL

- 1" to 4" FIPT Connections
- (2) Pressure Gauges
- Blow Off Valve (Gate or Ball)
- All Stainless Steel
- Galvanized Barrel
- Larger Inlet and Outlet
- Air Relief Valve & 2" Half Coupler
- Flanged Connections

**24 Gage
Stainless Steel Screen**

- 1/32" - .031" Protection for most systems
- 3/64" - .045" Protection for most systems
- 3/32" - .094" Protection for most systems

**New 24 Gage Perforated
Sizes Available**

Add 10% to filter price for these two sizes

- 1/8" - .125" Coarse system protection
- 1/4" - .250" Coarse system protection

MODEL	GPM	A	B	C	D	BLOW OFF OUTLET	WEIGHT	REPLACEMENT SCREENS	EPOXY	GALVANIZED
M80	70	27"	2" FIPT	6"	15 3/4"	1"	29			
M150	130	39"	3" FIPT	6"	27 3/4"	1"	42			

Filters Available In All 304 Stainless Steel Construction Call For Prices

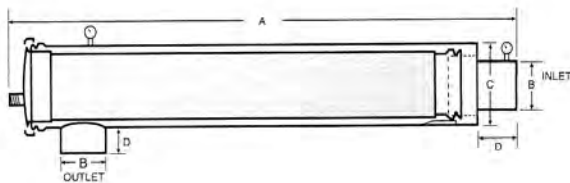

No. 2187

STANDARD

- Stainless Steel Body
- Ring Band Lock
- Replaceable Gaskets
- Can Be Welded Into Line
- Stainless Steel Screens
- Self-Cleaning Blow Off

OPTIONAL

- (2) Pressure Gauges
- Blow Off Valve (Gate or Ball)
- Air Relief Valve & 2" Half Coupler
- Flanged, Ringlock, or Victaulic Ends
- Larger Blow Off up to 4"
- Outlet In Any Position

**24 Gage
Stainless Steel Screen**

- 1/32" - .031" Protects pivots and other systems or
- 3/64" - .045" Protects pivots and other systems or
- 3/32" - .094" Protects pivots and other systems

**New 24 Gage Perforated
Sizes Available**

Add 10% to filter price for these three sizes

- .020"
- 1/8" - .125"
- 1/4" - .250"

MODEL	GPM	A	B	C	D	BLOW OFF OUTLET	WEIGHT	REPLACEMENT SCREENS
275AS	275	68"	4"	8"	6"	1	170	
475AS	475	70"	6"	12"	6"	2	120	
700AS	700	77"	8"	14"	6"	2 1/2	170	
1200AS	1200	130.5"	8-10"	14"	6"	2 1/2	230	



Manufacturers and Distributors of Irrigation and Industrial Equipment
 6983 Supply Way • Boise, Idaho 83716
 (208) 345-2525 / Toll Free 1-800-635-5975
 FAX 1-208-345-2143
 www.clemonssales.net
 e-mail purchasing@clemonssales.net

Made In USA

STURGEON

SELF-CLEANING SUCTION SCREENS – BUBBLERS

For Bottom Applications

No. ST

MODEL	GPM RATING	FISH SCREEN MAX. GPM FOR .4 FT. PER SEC. 12 MESH	CANISTER DIAMETER	BARE OUTLET	RETURN INLET	GPM TO OPERATE	STD. BRASS	SEALED	HEIGHT	WEIGHT	REPLACEMENT GALV. SPRAY WAND
							BEARING REC. OPERATING PRESSURE	BEARING REC. OPERATING PRESSURE			
ST4	350	160	18"	4"	1 1/2"	20	40 - 65	40 - 100	13"	62	
ST6	450	200	20"	6"	1 1/2"	20	40 - 65	40 - 100	13	73	
ST8	800	290	24"	8"	1 1/2"	20	40 - 65	40 - 100	17 1/2"	99	
ST10	1200	515	32"	10"	1 1/2"	20	40 - 65	40 - 100	17 1/2"	187	
ST12	1800	725	38"	12"	1 1/2"	20	40 - 65	40 - 100	19 1/2"	220	

- Replacement Brass Bearing
- Replacement Sealed Bearing
- Replacement Vee Jets

REQUIRED – Filter Strainer on Supply Line To Sturgeon Filter. See Page 15.

STANDARD – Galvanized Body With Stainless Steel 12 Mesh Screen – Plain End Outlet

OPTIONAL – Stainless Mesh Size – Connection on Sturgeon Outlet – Flanged, King Nipple, Ring Lock, Victaulic, or Water Tight Coupler.
NEW Sealed Bearing, 40 P.S.I. Required To Operate Sealed Bearing, Operating Range 40 to 100 P.S.I.



Bubbler Tops

**12 Mesh Stainless with
Painted Steel Frame**

No. B1000



SIZE	WEIGHT
38" with 6 3/4 Hole	49
44" with 8 7/8 Hole	64
50" with 8 7/8 Hole	76
52" with 8 7/8 Hole	82
56" with 10 7/8 Hole	93
62" with 10 7/8 Hole	107
66" with 12 7/8 Hole	118
74" with 12 7/8 Hole	144
76" with 12 7/8 Hole	150
86" with 12 7/8 Hole	180
90" with 12 7/8 Hole	198
98" with 14 1/8 Hole	232

Other Hole Sizes Available At Same O.D. Price

Manufacturers and Distributors of Irrigation and Industrial Equipment
 6983 Supply Way • Boise, Idaho 83716
 (208) 345-2525 / Toll Free 1-800-635-5975
 FAX 1-208-345-2143
 www.clemonssales.net
 e-mail purchasing@clemonssales.net



Made In USA

CLEARWATER SELF-CLEANING SUCTION SCREENS

Installation and Operating Instructions pg.40 & 41

Clearwater Screens Operate In Any Position

MODEL	FLOW		FISH SCREEN MAX. GPM FOR .4 FT. 12 MESH	OPEN SCREEN LENGTH	D	TOTAL LENGTH	DIAMETER	FLANGE SIZE	RETURN INLET	GPM USED TO OPERATE	STD. BRASS	SEALED	WEIGHT LBS.
	U.S. GPM 12/18M	24M									BEARING REC. OPERATING PRESSURE	BEARING REC. OPERATING PRESSURE	
CW100	200	165	180	9"	7.8"	19.5"	12"	3"	1/2"	12	40-60	N/A	30
CW200	375	225	355	11"	11.5"	25"	16"	4"	1 1/2"	20	40-65	40-100	58
CW400	550	400	485	15"	10.6"	28.8"	16"	6"	1 1/2"	20	40-65	40-100	62
CW600	750	525	775	16"	11.6"	32.5"	24"	8"	1 1/2"	20	40-65	40-100	102
CW800	950	700	875	18"	11.1"	34.5"	24"	10"	1 1/2"	20	40-65	40-100	115
CW1000	1350	950	1115	23"	11.1"	39.5"	24"	10"	1 1/2"	28	40-65	40-100	123
CW1400	1550	1075	1265	26"	11.3"	42.5"	24"	12"	1 1/2"	28	40-65	40-100	131
CW1700	1800	1250	1475	28"	12.0"	44.5"	26"	12"	1 1/2"	28	40-65	40-100	148
CW2000	2100	1450	1685	32"	11.6"	48.5"	26"	14"	1 1/2"	36	40-65	40-100	160
CW2400	2600	1800	2125	35"	11.6"	52.5"	30"	16"	1 1/2"	36	40-65	40-100	223
CW3000	3000	2075	2430	40"	11.6"	57.5"	30"	16"	1 1/2"	44	40-65	40-100	236
CW3500	3500	2420	2750	40"	12.8"	59.5"	36"	18"	1 1/2"	44	40-65	40-100	283
CW4000	4000	2765	3150	40"	14.0"	63.5"	42"	18"	1 1/2"	44	40-65	40-100	358

Mini Inline Filter – Model M150 Epoxy

Stainer (Clear) 1 1/2" Solvent Weld 60 to 70 GPM

Strainer (Clear) 2" Solvent Weld 70 to 100 GPM

} Purging Without Removing Screen

New Flow Entry Control Vortex Tube Option - See Pricing On Page 17

Mesh Sizes Available 4, 8, 12, 18, and 24 – (12 Mesh Is Standard)

Special Connections Available - Call For Pricing

To Change Out A Brass Bearing To A Sealed Bearing You Need To Change The 1 1/2" Pipe Nipple That The Bearing Attaches To For One That Is 2" Shorter

Brass and Sealed Bearings Come In One Size - Fits All Models

Except for the CW100

*Models 3000, 3500, 4000

Offered Only with Sealed Bearing

**HIGH PRESSURE SEALED
BEARING 40-100 PSI**



BRASS BEARING 40-65 PSI

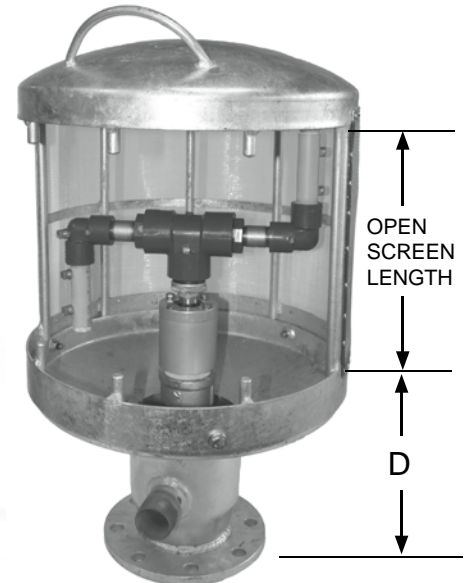

Trouble free operation under the worst conditions.
40 P.S.I. required to operate sealed bearing.
100 P.S.I. maximum operating pressure.



Manufacturers and Distributors of Irrigation and Industrial Equipment
6983 Supply Way • Boise, Idaho 83716
(208) 345-2525 / Toll Free 1-800-635-5975
FAX 1-208-345-2143
www.clemonssales.net
e-mail purchasing@clemonssales.net

Made In USA

— NEW WIDE WAND —

CLEARWATER SELF-CLEANING SUCTION SCREENS

Sealed Bearing Standard - Installation and Operating Instructions pg.40 & 41

Wide wand self cleaning suction screens are designed for heavy debris applications. Spray wands are moved closer to the mesh screen and two extra spray jets are added. Two extra spray jets maximizes the CW's cleaning ability and increases the operating flow by 8GPM per unit over our standard clearwater screens. Wide wand CW's come standard with sealed bearings.

MODEL	FLOW		FISH SCREEN MAX. GPM FOR .4 FT. PER SEC. 12 MESH	SCREEN LENGTH	TOTAL LENGTH	DIAMETER	FLANGE SIZE	RETURN INLET	GPM USED TO OPERATE	SKID PLATE OPTION	SEALED BEARING REC. OPERATING PRESSURE	WEIGHT LBS.	OPTION VORTEX
	U.S. GPM	24M											
CW600WW	750	525	775	16"	32.5"	24"	8"	1 1/2"	28	\$ 287.86	40-100	104	
CW800WW	950	700	875	18"	34.5"	24"	10"	1 1/2"	28	287.86	40-100	117	
CW1000WW	1350	950	1115	23"	39.5"	24"	10"	1 1/2"	36	287.86	40-100	125	
CW1400WW	1550	1075	1265	26"	42.5"	24"	12"	1 1/2"	36	287.86	40-100	133	
CW1700WW	1800	1250	1475	28"	44.5"	26"	12"	1 1/2"	36	287.86	40-100	151	
CW2000WW	2100	1450	1685	32"	48.5"	26"	14"	1 1/2"	44	383.46	40-100	162	
CW2400WW	2600	1800	2125	35"	52.5"	30"	16"	1 1/2"	44	383.46	40-100	223	
CW3000WW	3000	2075	2430	40"	57.5"	30"	16"	1 1/2"	52	383.46	40-100	238	
CW3500WW	3500	2420	2750	40"	59.5"	36"	18"	1 1/2"	52	383.46	40-100	285	
CW4000WW	4000	2765	3150	40"	63.5"	42"	18"	1 1/2"	52	383.46	40-100	360	
Mini Inline Filter – Model M150 Epoxy													
Stainer (Clear) 1 1/2" Solvent Weld 60 to 70 GPM } Purging Without Removing Screen													
Strainer (Clear) 2" Solvent Weld 70 to 100 GPM }													

New Flow Entry Control Vortex Tube Option

HIGH PRESSURE SEALED BEARING 40 - 100 P.S.I. Operating Range

Standard in all Wide Wand models.



Mesh Sizes Available
4, 8, 12, 18, and 24 – (12 Mesh Is Standard)

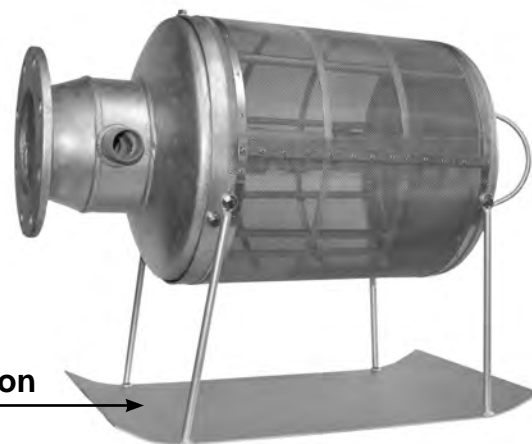

Skid Plate Option →

Wide Wand CW Models Operate In Any Position

Manufacturers and Distributors of Irrigation and Industrial Equipment
6983 Supply Way • Boise, Idaho 83716
(208) 345-2525 / Toll Free 1-800-635-5975
FAX 1-208-345-2143
www.clemonssales.net
e-mail purchasing@clemonssales.net



Made In USA

CLEARWATER PARTS – 50 TO 200 GPM DIFFUSER SUCTION SCREENS

Parts – Accessories

	PART No.
Replacement Bearing CW100	2013
Replacement Bearing Brass (Models CW200 - CW2400)	2014
Replacement Vee Jets	2015
Replacement Vee Jets S.S.	2016
Sealed Heavy Duty Bearing (Models CW200 - CW4000)	2017
Sealed Bearing Repair Kit (No Shaft)	2018
Sealed Bearing Shaft Only	2019
Skid Plates CW200 - 400	2020
Skid Plates CW600 - 1700	2021
Skid Plates CW2000 - 3000	2022



No. 2023 STANDARD REPLACEMENT SPRAY ASSEMBLY LESS BEARING	No. 2024 WIDE WAND REPLACEMENT SPRAY ASSEMBLY LESS BEARING	No. 2025 REPLACEMENT 12 MESH SCREEN	No. 2026 REPLACEMENT 18 & 24 MESH SCREEN
--	---	---	--

MODEL
CW200
CW400
CW600
CW800
CW1000
CW1400
CW1700
CW2000
CW2400
CW3000
CW3500
CW4000



No. DS

50 To 200 GPM Diffuser Style Suction Screen

MODEL	FISH FRIENDLY		OVERALL LENGTH	DIAMETER	STANDARD S.S. SCREEN	WEIGHT
	MAX. GPM RATING	INLET CONNECTION				
DS50	0-50	2" FPT	17"	6"	3/32" Perf.	14
DS100	50-100	3" FPT	21 1/2"	10"	3/32" Perf.	27
DS200	100-200	4" FPT	30 1/4"	14"	3/32" Perf.	49



Manufacturers and Distributors of Irrigation and Industrial Equipment
 6983 Supply Way • Boise, Idaho 83716
 (208) 345-2525 / Toll Free 1-800-635-5975
 FAX 1-208-345-2143
 www.clemonssales.net
 e-mail purchasing@clemonssales.net

304 STAINLESS STEEL SCREEN – LINE STRAINERS

No. 4025

**Made In USA
Perforated
Screen**

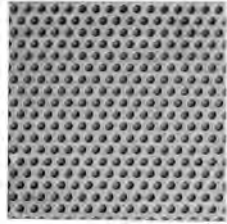

Mesh Screen

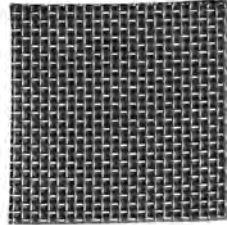

**Other
Sizes
Available**

MATERIAL	GA.	HOLE SIZE
Stainless	26 Ga.	1/32" = .031
(3' x 10' sheets)	24 Ga.	3/64" = .045
Perforated	24 Ga.	3/32" = .094
	22 Ga.	1/8" = .125
	22 Ga.	3/16" = .188
	22 Ga.	1/4" = .250

Stainless	24 Ga.	3/64" = .045
(4' x 10' sheets)	22 Ga.	3/32" = .094
Perforated		

ROLL WIDTH		WIRE	
		DIA.	
4'	4 Mesh S.S.	.047	.203
4'	8 Mesh S.S.	.028	.097
5'	12 Mesh S.S.	.023	.060
4'	18 Mesh S.S.	.017	.039
4'	24 Mesh S.S.	.014	.028

Mesh Is Sold by the Linear Foot off the Roll, See Roll Width

Made In USA

304 Stainless Steel Lateral Line Strainers 3/32" Holes Standard

FOR OPEN END TUBE No. 2190



NOMINAL SIZE	LENGTH	RING I.D.	RING O.D.
2	18	1 3/4	2
3	18	2 1/2	3
3	36	2 1/2	3
4	18	3 1/2	4
4	36	3 1/2	4
5	36	4 1/2	5
6	36	5 1/2	6
7	36	6 1/2	7
8	36	7 1/2	8
10	36	9 1/2	10

*Add 40% for Different Hole Sizes

FOR BULLNOSE OR ROLLED END TUBE

No. 2195

Bullnose

No. 2196

Rolled End

NOMINAL SIZE	LENGTH	RING I.D.	RING O.D.	RING I.D.	RING O.D.
2					
3					
3		OPEN END FITS ALL TYPES IN 2" AND 3" ONLY			
4	18	3 1/2	4	3 3/8	3 7/8
4	36	3 1/2	4	3 3/8	3 7/8
5	36	4 3/8	4 7/8	4 1/4	4 3/4
6	36	5 1/4	5 3/4	5 1/8	5 5/8
8	36	7 1/4	7 3/4	7 1/8	7 5/8

Manufacturers and Distributors of Irrigation and Industrial Equipment
 6983 Supply Way • Boise, Idaho 83716
 (208) 345-2525 / Toll Free 1-800-635-5975
 FAX 1-208-345-2143
 www.clemonssales.net
 e-mail purchasing@clemonssales.net



Made In USA
SPRINKLER DEFLECTORS – BASKET STRAINERS

Sprinkler Deflectors – Stainless Steel Screen



Half circle pattern to protect field or roadway

Bolts to Riser
No. 3095



Guard for mounting on Riser 3/4"
No. 3096



Guard for mounting on self-leveler
No. 3097

Basket Strainers – 1/2" Mesh

No. 3090



– 304 STAINLESS STEEL –
 NEW NEW
 STAINLESS STAINLESS
 STEEL STEEL
 LESS CLIPS WITH CLIPS

SIZE	GALV. LESS CLIPS	ENAMELED LESS CLIPS	GALV. WITH CLIPS	ENAMELED WITH CLIPS	– 304 STAINLESS STEEL – NEW STAINLESS STEEL LESS CLIPS	NEW STAINLESS STEEL WITH CLIPS
O.D.						
4						
5						
6						
8						
10						
12						
14						
16						



Manufacturers and Distributors of Irrigation and Industrial Equipment
 6983 Supply Way • Boise, Idaho 83716
 (208) 345-2525 / Toll Free 1-800-635-5975
 FAX 1-208-345-2143
 www.clemonssales.net
 e-mail purchasing@clemonssales.net

Made In USA CLEMONS CENTRIFUGAL SAND SEPARATORS

(See Separator Product Brochure or pgs.42, 43, 44
For Specifications And Installation)



Clemons Vertical In-Line Separators (Steel)

MODEL	FLOW		SIZE	LENGTH	WEIGHT
	GPM	M3/Hr			LBS.
R5V	4-10	.9-2.3	1/2"	20"	13
R7V	10-20	2.3-4.6	3/4"	20"	15
R10V	18-38	4-8.7	1"	30 1/2"	26
R12V	26-52	6-12	1 1/4"	30 1/2"	26
R15V	38-79	8.7-18	1 1/2"	30 1/2"	26
R20V	63-120	14.5-27.6	2"	36"	44
R25V	100-180	23-41.4	2 1/2"	44"	55
R30V	125-260	28.7-59.8	3"	48"	75
R40V	190-345	43.7-79.4	4"	52"	120

Larger Sand Chambers Available

Minimum Operating Pressure 30 P.S.I. For Both LA & Vertical Models

Clemons Heavy Duty Centrifugal Separators

(Model LA – 22 1/2 Degree Angle)

MODEL	FLOW		FLANGE SIZE	SHIPPING LENGTH	WEIGHT
	GPM	M3/Hr			LBS.
R40LA	200-400	46-120	4"	87"	280
R60 LA LF	365-700	84-162	6"	115 1/2"	493
R60LA HF	500-950	116-220	6"	115 1/2"	493
R80LA	800-1600	184-369	8"	124 3/4"	722
R100LA	1300-2300	299-529	10"	135"	840
R120LA	2025-3400	465-782	12"	156"	1400
R140LA	2975-5000	684-1150	14"	167"	2000
R160LA	4000-6200	920-1426	16"	182"	2310
R180LA	5000-7800	1150-1794	18"	192"	2750

See Page 44
for LA Model
Pictures,
Dimensions,
and Flow Chart.

Clemons Sand Separator Accessories

	PART No.
2 Steel straps for Models R7V-R40V Separators for mounting on wall	2027
Legs for R7V-R40V Separators for self standing	2028
Manual Purge Valve & Fitting for Model R5V-R15V Separators (1" Nipple and Ball Valve)	2029
Manual Purge Valve & Fittings for Model R20V-R40V Separators (2" Nipple and Ball Valve)	2030
Auto Controller & Purge Valve (Electric) – 1" Brass Valve (Superior Brand) Pictured pg.46	2031
Auto Controller & Purge Valve (Electric) – 2" Brass Valve (Superior Brand) Pictured pg. 46	2032
Controller Only – Operation pg. 46-47	2033
1" Purge Valve Only (Superior Brand – Brass)	2034
2" Purge Valve Only (Superior Brand – Brass)	2035
Auto Controller & 2" Motorized Ball Valve – Catalog page 29	3001

Copper tube and brass fittings necessary for proper installation for above valve and controller supplied at no charge when ordered with separator.

Manufacturers and Distributors of Irrigation and Industrial Equipment
6983 Supply Way • Boise, Idaho 83716
(208) 345-2525 / Toll Free 1-800-635-5975
FAX 1-208-345-2143
www.clemonssales.net
e-mail purchasing@clemonssales.net



ENBEE BUTTERFLY VALVES



- Pressure – 200 lbs. P.S.I. 2" - 12"
- Pressure – 150 lbs. P.S.I. 14" - 16"
- Body – Cast Iron
- Disc – Ductile Iron
- Shaft – 400 Series Stainless
- Seat – EPDM
- Torque – Low Operating



No. 3085

Butterfly Valves

SIZE	WT.	VALVE WIDTH	WEIGHT
2"	8	1.65"	17
3"	10	1.77"	20
4"	13	1.97"	23
5"	18	2.15"	27
6"	20	2.17"	29
8"	35	2.28"	47
10"	48	2.70"	60
12"		3.07"	85
14"		3.07"	125
16"		4.02"	143

No. 3005

Handle Extensions

LIST PRICE – FEET

SIZE	3	4	6
4"			
5"			
6"			
8"			
10"			
12"			

4", 5", and 6" Replacement Lever Handles
8", 10", and 12" Replacement Lever Handles

3"-6" Gear Head Only with Wheel
8"-10" Gear Head Only with Wheel
12" Gear Head Only with Wheel

No. 2125



Butterfly Type – Long Irrigation Set

SIZE	WEIGHT	SIZE	WEIGHT
2	2	6	7
3	2	8	7
4	4	10	16
5	7	12	16

Bolt Lengths are for 1/2" Thick Flanges



Manufacturers and Distributors of Irrigation and Industrial Equipment
6983 Supply Way • Boise, Idaho 83716
(208) 345-2525 / Toll Free 1-800-635-5975
FAX 1-208-345-2143
www.clemonsales.net
e-mail purchasing@clemonsales.net

ENBEE DOUBLE DOOR CHECK VALVE



- Body Materials – Cast Iron – ASTM A126B
- Trim Material – 316 SST – Spring
- Disc Materials – Nickel Plated Ductile Iron
- Seal Material – EPDM
- Working Pressure – 200 P.S.I.

No. 3086 Enbee Check Valves

SIZE	WEIGHT	VALVE WIDTH
2	4	1.75"
3	8	2.50"
4	13	2.50"
5	17	2.75"
6	20	3.00"
8	38	3.50"
10	58	4.50"
12	93	4.50"
14	110	5.00"
16	140	5.50"

Larger Sizes Available

Install At Least 5 Pipe Diameters from Pump Discharge

No. 2126

Enbee Check Valve Type – Long Irrigation Set

Includes two non asbestos ring gaskets



SIZE	WEIGHT	SIZE	WEIGHT
2	2	6	7
3	2	8	7
4	4	10	16
5	7	12	16

Bolt Lengths are for 1/2" Thick Flanges

Manufacturers and Distributors of Irrigation and Industrial Equipment
 6983 Supply Way • Boise, Idaho 83716
 (208) 345-2525 / Toll Free 1-800-635-5975
 FAX 1-208-345-2143
www.clemonssales.net
 e-mail purchasing@clemonssales.net



Made In USA

SPRING LOADED CHECK VALVES

(Stainless Steel Hinge and Springs – Vulcanized Rubber Gates)

(Parts Page 27)

Check Valve, Spring Swing

Plain Inlet x Plain Outlet



3/4" Drain Coupler
Optional

No. 3060

*12" Cones with 10" Body

	SIZE	WT.	VALVE LENGTH	GALV.	ENAMELED
	4"	12	14.00"		
	5"	15	14.00"		
	6"	17	13.75"		
	8"	29	15.00"		
	10"	39	16.38"		
	*12"	42	19.38"		

NEW 12" Full Port – See Page 25

Check Valve, Spring Swing

Flange Inlet x Flange Outlet



No. 3065

*12" Flanges with 10" Body

	SIZE	WT.	VALVE LENGTH	GALV.	ENAMELED
	4"	27	14.63"		
	5"	29	14.63"		
	6"	35	14.38"		
	8"	52	15.63"		
	10"	73	17.13"		
	*12"	88	19.75"		

NEW 12" Full Port – See Page 25

NOTE: All Check Valves last longer if placed 5 pipe diameters away from pump.

Chemigation Valve with 4" Inspection Port

Flanged – Galvanized



No. 3070

*12" Flanges with 10" Body

	SIZE	WT.	VALVE LENGTH
	4"	36	24.63"
	6"	51	24.38"
	8"	71	25.75"
	10"	90	27.25"
	*12"	115	26.50"

NEW 12" Full Port – See Page 25

Chemigation Adapter Spools

Galvanized or Epoxy



No. 3075

No. 3076 Low Pressure Drain only

FLANGE X FLANGE

SIZE
6"
8"
10"



No. 3077

Chemigation Cap

4" RLM x 2" MPT

Chemigation Valves feature non-slamming positive seal, stainless steel hinge assembly and air springs. Vulcanized rubber gate and machined seat, standard 4" Inspection Port, 2" nipple for air vent, 4" ring lock, 3/4" injection port and drain port, drain valve included. Each valve tested at the factory.



Manufacturers and Distributors of Irrigation and Industrial Equipment
 6983 Supply Way • Boise, Idaho 83716
 (208) 345-2525 / Toll Free 1-800-635-5975
 FAX 1-208-345-2143
 www.clemonssales.net
 e-mail purchasing@clemonssales.net

Made In USA
SPRING LOADED CHECK VALVES
(Stainless Steel Hinge and Springs – Vulcanized Rubber Gates with Rubber Seat)
(Parts Page 27)



3/4" Drain Coupler
Optional

Check Valve, Spring Swing

Plain Inlet x Plain Outlet

No. 3040

Rubber-To-Rubber

Seat

*12" Cones with 10" Body
NEW – Full 12" Opening

SIZE	WT.	VALVE	
		LENGTH	GALVANIZED ENAMELED
6"	17	13.75"	
8"	29	15.00"	
10"	39	16.38"	
12"	42	19.38"	
12" FP	64	21.00"	



Check Valve, Spring Swing

Flange Inlet x Flange Outlet

No. 3045

Rubber-To-Rubber

Seat

*12" Flanges with 10" Body
NEW – Full 12" Opening

SIZE	WT.	VALVE	
		LENGTH	GALVANIZED ENAMELED
6"	35	14.38"	
8"	52	15.63"	
10"	73	17.13"	
12"	88	19.75"	
12" FP	139	21.63"	

NOTE: All Check Valves last longer if placed 5 pipe diameters away from pump.



Chemigation Valve with 4" Inspection Port

Flanged – Galvanized

No. 3050

Rubber-To-Rubber

Seat

*12" Flanges with 10" Body
NEW – Full 12" Opening

SIZE	WT.	VALVE
		LENGTH
6"	51	24.38"
8"	71	25.75"
10"	90	27.25"
12"	115	26.50"
12" FP	160	31.63"



No. 3077
Chemigation Cap

4" RLM x 2" MPT



Chemigation Adapter Spools

Galvanized or Epoxy

No. 3075

SIZE	FLANGE X FLANGE
	6"
8"	
10"	

No. 3076 Low Pressure Drain only

Chemigation Valves feature non-slamming positive seal, stainless steel hinge assembly and air springs. Vulcanized rubber gate and machined seat, standard 4" Inspection Port, 2" nipple for air vent, 4" ring lock, 3/4" injection port and drain port, drain valve included. Each valve tested at the factory.

Manufacturers and Distributors of Irrigation and Industrial Equipment
 6983 Supply Way • Boise, Idaho 83716
 (208) 345-2525 / Toll Free 1-800-635-5975
 FAX 1-208-345-2143
 www.clemonssales.net
 e-mail purchasing@clemonssales.net



Made In USA

FOOT VALVES

(Parts Page 27)

Spring-Loaded Foot Valves – Drain Standard



3/4" Drain Coupler
Standard On
Foot Valves

NEW RUBBER-TO-RUBBER SEAT			No. 3020	No. 3021
SIZE	WT.	VALVE LENGTH	FLANGED GALV. BARREL & SCREEN	FLANGED ENAMELED BARREL & SCREEN
6"	31	21.63"		
8"	42	22.25"		
10"	58	24.00"		
*12"	75	23.75"		
*12" Flanges with 10" Body				
12" FP	119	33.25"		
NEW – Full 12" Opening				

NEW RUBBER-TO-RUBBER SEAT			No. 3030	No. 3031
SIZE	WT.	VALVE LENGTH	FLANGED GALV. BARREL & SCREEN	FLANGED ENAMELED BARREL & SCREEN
4"	22	19.88"		
5"	26	21.75"		
6"	31	21.63"		
8"	42	22.25"		
10"	58	24.00"		
*12"	75	23.75"		
*12" Flanges with 10" Body				

NEW RUBBER-TO-RUBBER SEAT			No. 3022	No. 3023
SIZE	WT.	VALVE LENGTH	BARE WITH GALV. BARREL & SCREEN	BARE WITH ENAMELED BARREL & SCREEN
6"	23	21.00"		
8"	32	21.88"		
10"	45	23.50"		
*12"	47	23.50"		
*12" Cones with 10" Body				
12"FP	72	32.25"		
NEW – Full 12" Opening				

NEW RUBBER-TO-RUBBER SEAT			No. 3032	No. 3033
SIZE	WT.	VALVE LENGTH	BARE GALV. BARREL & SCREEN	BARE ENAMELED BARREL & SCREEN
4"	16	19.13"		
5"	18	21.13"		
6"	23	21.00"		
8"	32	21.88"		
10"	45	23.50"		
*12"	47	23.50"		
*12" Cones with 10" Body				

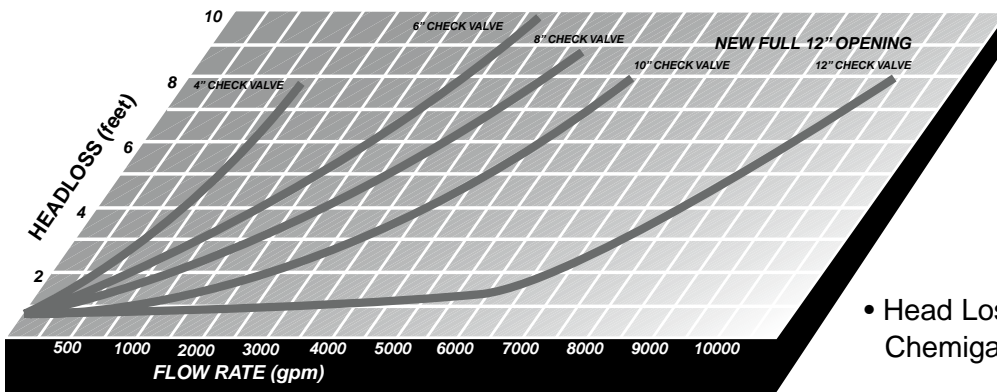

- Head Loss Chart for Check and Chemigation Valves
- Two Feet of Head is Required to Open the Gates on Foot, Check, and Chemigation Valves



Manufacturers and Distributors of Irrigation and Industrial Equipment
 6983 Supply Way • Boise, Idaho 83716
 (208) 345-2525 / Toll Free 1-800-635-5975
 FAX 1-208-345-2143
 www.clemonssales.net
 e-mail purchasing@clemonssales.net

304 STAINLESS STEEL REPLACEMENT PARTS FOR CHECK VALVES, FOOT VALVES AND CHEMIGATION VALVES

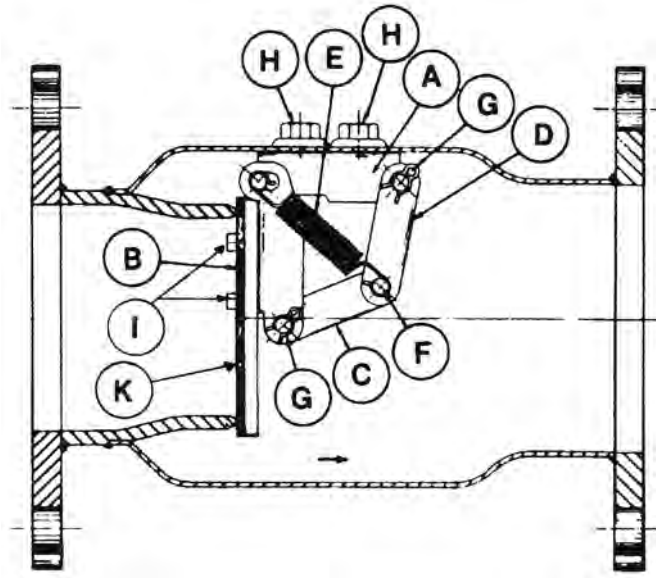

No. 3080

Mounting link bolts are special – DO NOT substitute with standard screws.

VALVE SIZE	4"	5"	6"	8"	10"	12"
A. Mounting Link S.S.						
B. Gasket Plate Link S.S.						
C. Inner Link S.S.						
D. Outer Link S.S.						
E. Link Spring S.S. (2 reqd.)						
F. Link Pin S.S. (4 reqd.)						
G. Link Pin Clip S.S. (12 reqd.)						
H. Mounting Link Screw (2 reqd.) – Plated						
I. Plate Link Screw (2 reqd.) – Plated						
J. Plate Link Nuts (2 reqd.) – Plated						
K. Gasket Plate – Plated						
L. Complete Plate & Spring Assembly New Rubber O-Ring Seat						

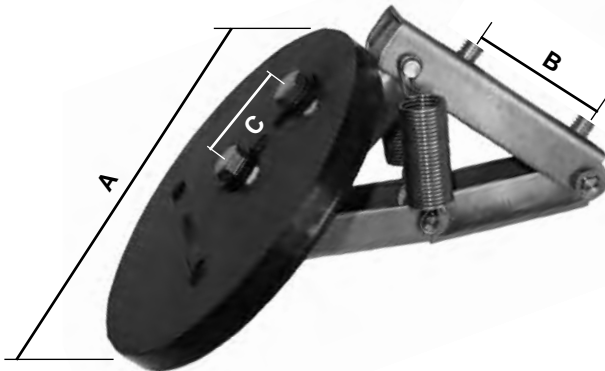

No. 3080-L

SIZE	DIMENSIONS			WEIGHT
	A	B	C	
4"	4.5"	2.5"	1.18"	2.2
5"	5.5"	2.5"	1.63"	2.9
6"	6.5"	2.5"	1.63"	3.7
8"	8.63"	3.0"	2.63"	7.9
10"	10.75"	4.25"	3.63"	11.7
12"	12.75"	4.5"	4.25"	16.3

Manufacturers and Distributors of Irrigation and Industrial Equipment
 6983 Supply Way • Boise, Idaho 83716
 (208) 345-2525 / Toll Free 1-800-635-5975
 FAX 1-208-345-2143
 www.clemonssales.net
 e-mail purchasing@clemonssales.net



Made In USA
304 STAINLESS STEEL
SPRING LOADED CHECK AND FOOT VALVES



3/4" Drain Coupler
Optional

Check Valve, Spring Swing

Plain Inlet x Plain Outlet

	SIZE	WT.
No. 3060-SS 6", 8", 10", and 12" Have Rubber-to-Rubber Seat	4"	12
	5"	15
	6"	17
	8"	29
	10"	39
	12"	42



Check Valve, Spring Swing

Flange Inlet x Flange Outlet

	SIZE	WT.
No. 3065-SS 6", 8", 10", and 12" Have Rubber-to-Rubber Seat	4"	27
	5"	29
	6"	35
	8"	52
	10"	73
	12"	88

NOTE: All Check Valves last longer if placed 10 pipe diameters away from pump.

304 Stainless Steel
Spring-Loaded Foot Valves



3/4" Drain Coupler
Standard

6", 8", 10", and 12" SS Foot Valves
Have Rubber-to-Rubber Seat

No. 3SSB
BARE
STAINLESS
STEEL
BARREL
& SCREEN

No. 3SSF
FLANGED
STAINLESS
STEEL
BARREL
& SCREEN

SIZE	WT.
4"	22
5"	26
6"	31
8"	42
10"	58
12"	75



Manufacturers and Distributors of Irrigation and Industrial Equipment
 6983 Supply Way • Boise, Idaho 83716
 (208) 345-2525 / Toll Free 1-800-635-5975
 FAX 1-208-345-2143
 www.clemonssales.net
 e-mail purchasing@clemonssales.net



GATE AND BALL VALVES NOT FOR POTABLE WATER

Brass Gate Valves

IPS Threads

No. 574

SIZE	PCS./ CASE	PCS./ INNER CASE	WT./ CASE
1/4	120	10	71
3/8	120	10	71
1/2	120	10	71
3/4	80	10	63
1	60	5	58
1 1/4	40	5	66
1 1/2	30	5	65
2	24	2	74
2 1/2	10	1	60
3	6	1	47
4	4	1	50

FEATURES

- Cast Brass Construction
- Heavy Pattern
- Wedge Disc
- Non Rising Stem
- Heavy Duty Cast Handle
- Working Pressure – 200

P.S.I.



Brass Ball Valves

IPS Threads

No. 759

SIZE	PCS./ CASE	PCS./ INNER CASE	WT./ EACH
1/4	120	15	.04
1/2	120	15	.04
3/4	60	10	.08
1	48	8	1.1
1 1/4	24	4	2.0
1 1/2	24	2	3.1
2	12	2	4.2
2 1/2	6	2	8.0
3	4	1	13.0
4	2	1	22.0

VALVE FEATURES

- Forged Brass Construction
- Working Pressure 600 WOG
- Teflon Seats
- Full Port
- Conforms to MSS-SP-110

No. 3001

2" Motorized Ball Valve

SIZE	DESCRIPTION
2"	Apollo 2" full port bronze ball valve with S.S. trim Apollo AE800 – 10 electric actuator
120 or 24 Volt	Diversified Electronics adjustable control timer 1/4 to 12 hours Perfect For Purging Separators and Filters. Contact Factory For Other Sizes



Manufacturers and Distributors of Irrigation and Industrial Equipment
6983 Supply Way • Boise, Idaho 83716
(208) 345-2525 / Toll Free 1-800-635-5975
FAX 1-208-345-2143
www.clemonssales.net
e-mail purchasing@clemonssales.net



VALVES

Cast Iron Gate Valves

No. 10GW



FEATURES

- 200 P.S.I. WOG
- Bubble Tight Shut-Off
- Full Port Flow – Low Head Loss
- Epoxy Coated – Internal and External
- Vulcanized Encapsulated Resilient Wedge
- Stainless Steel Stem – Corrosion-Free
- Easy In-Line Service
- Optional 2" Op. Nut

SIZE	WEIGHT	VALUE LENGTH
3	42	8.00"
4	64	9.00"
5	97	10.00"
6	108	10.50"
8	192	11.50"
10	286	13.00"
12	392	14.00"

Straight Line Valve – Plain End, Both Ends Galvanized

No. 3112



SIZE	WEIGHT
4	18
5	23
6	23
8	55
10	77
12	108

Available with different fittings on inlet and outlet.

Galvanized SURGE PLUGS



No. 3185

MALE THREAD END

SIZE	WEIGHT
3 x 3	9
4 x 4	10

No. 3190

RING LOCK END

SIZE	WEIGHT
4	8
5	9
6	11
8	12

AIR RELIEF VALVES – RING LOCK FITTINGS

Aluminum Air and Vacuum RELIEF VALVES



No. 3180

SIZE	WEIGHT
2	1 1/2
3	3

Zinc Plated RING BAND LOCK



No. 3072
RING BAND LOCK

SIZE	WEIGHT
3	1 3/4
4	2
5	2
6	3
8	3
10	5
12	7

Hose Adapter No. 4070



SIZE	WELD END	HOSE END	WEIGHT
3"	3"	3"	2.0
4"	4"	4"	3.0
5"	5"	5"	4.5
6"	6"	6"	7.0
8"	8"	8"-12 ga.	9.0
10"	10"	10"-12 ga.	11.0
12"	12"	12"-12 ga.	14.0

Weld-On-Steel – Ring Lock PUMP STARTERS 12 GA & 10 GA with gasket



No. 3025
Female



No. 3015
Male

SIZE	NO.	NO.	NO.	NO.
	3015 12 GA	3025 12 GA	3015 10 GA	3025 10 GA
	MALE 12 GA	FEMALE 12 GA	MALE 10 GA	FEMALE 10 GA
3"				
4"			4"	
5"			5"	
6"			6"	
8"			8"	
10"			10"	
12"			12"	

Roundback Available

Manufacturers and Distributors of Irrigation and Industrial Equipment
 6983 Supply Way • Boise, Idaho 83716
 (208) 345-2525 / Toll Free 1-800-635-5975
 FAX 1-208-345-2143
 www.clemonssales.net
 e-mail purchasing@clemonssales.net



Made In USA
WATER TIGHT EPOXY FITTINGS
 Component Prices Catalog Page 12

Water Tight Half Coupler – Epoxy Coated

No. 7042

Includes Flange, Gasket, Bolts and Nuts.
 Plain end stripped for welding.



Specify Size
 IPS, PIP or O.D.

SIZE	OAL	WEIGHT	PIP, OD, IPS
3	9"	7.25	
4	9"	9.25	
5	9"	10.75	
6	9"	12.50	
8	9"	16.25	
10	9"	20.50	
12	9"	25.50	
15.3	9"	28.50	
18.7	9"	36.00	

Water Tight Expansion Couplers – Epoxy Coated

No. 7040

Includes Flange, Gasket, Bolts and Nuts.



Specify Size
 IPS, PIP or O.D.

SIZE	OAL	WEIGHT	PIP, OD, IPS
3	16"	14.00	
4	16"	17.75	
5	16"	20.75	
6	17"	24.75	
8	18"	33.00	
10	18"	41.50	
12	18"	51.75	
15.3	18"	58.00	
18.7	18"	74.00	

Water Tight Couplers – Epoxy Coated

No. 7035

Includes Flange, Gasket, Bolts and Nuts.



10" Body Length
 Specify Size
 IPS, PIP or O.D.

SIZE	OAL	WEIGHT	PIP, OD, IPS
3	10"	9.25	
4	10"	11.50	
5	10"	13.50	
6	10"	15.75	
8	10"	20.00	
10	10"	24.75	
12	10"	29.50	
15.3	10"	34.25	

The above fittings are for use with PVC Plastic Pipe (IPS and PIP sizes),
 Standard Pipe, Steel and Aluminum, and some Transite Pipe sizes



Manufacturers and Distributors of Irrigation and Industrial Equipment
 6983 Supply Way • Boise, Idaho 83716
 (208) 345-2525 / Toll Free 1-800-635-5975
 FAX 1-208-345-2143
 www.clemonssales.net
 e-mail purchasing@clemonssales.net

Made In USA
EPOXY FITTINGS

Compression Starter Coupler – Epoxy Coated

No. 7242



Plain End Stripped for Weld.
Includes Gasket.

SIZE	OAL	WEIGHT
3" IPS	8.75"	3.25
4" IPS	7.88"	3.40
5" IPS	7.50"	5.25
6" IPS	7.88"	6.25
8" IPS	7.88"	8.00
10" IPS	9.75"	10.25
12" IPS	9.75"	15.90
6" PIP	8.75"	6.25
8" PIP	8.75"	8.25
10" PIP	9.50"	10.25
12" PIP	9.88"	13.00
15" PIP	9.88"	20.00
18" PIP	9.88"	26.00

Compression Flange Adapter – Epoxy Coated

No. 7262



Other Configurations
Upon Request

SIZE	WEIGHT
4" IPS x 4" FL	10.00
5" IPS x 5" FL	12.00
6" IPS x 6" FL	14.50
8" IPS x 8" FL	20.50
10" IPS x 10" FL	26.00
12" IPS x 12" FL	35.00
6" PIP x 6" FL	13.00
8" PIP x 8" FL	21.50
10" PIP x 10" FL	25.00
12" PIP x 12" FL	34.00
15" PIP x 14" FL	51.00
15" PIP x 16" FL	51.00

Water Tight Flange Adapter – Epoxy Coated

No. 7062

Includes Flange, Gasket, Bolts and Nuts.



Specify Size
IPS, PIP or O.D.
Other Configurations
Upon Request

SIZE	WEIGHT
3 x 3" FL	10.50
4 x 4" FL	14.30
5 x 5" FL	15.30
6 x 6" FL	19.50
8 x 8" FL	26.50
10 x 10" FL	33.50
12 x 12" FL	44.00
15 x 14" FL	63.50
15 x 16" FL	63.50

Manufacturers and Distributors of Irrigation and Industrial Equipment
6983 Supply Way • Boise, Idaho 83716
(208) 345-2525 / Toll Free 1-800-635-5975
FAX 1-208-345-2143
www.clemonssales.net
e-mail purchasing@clemonssales.net



WATER TIGHT COUPLER PARTS



OD, PIP & IPS FLANGE, BOLT
& GASKET KIT

IPS, OD & PIP
WATER TIGHT
GASKET ONLY

	#7035	#7040	#7042	#7090
3				
4				
5				
6				
8				
10				
12				

Black Steel NIPPLES

No. 4040

Call For Sizes Not Listed

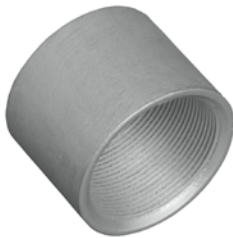

PIPE FITTINGS

DIAMETER	NIPPLE LENGTH					
	3"	4"	5"	6"	8"	10"
1/2"			\$			
3/4"						
1"						
1 1/4"						
1 1/2"						
2"						
2 1/2"						
3"						
4"						
5"						
6"						
8"						

Black Steel NIPPLES and COUPLINGS

No. 4045

SIZE	COUPLER		NIPPLE HALF
	FULL THREAD	HALF	
1/2"			
3/4"			
1"			
1 1/4"			
1 1/2"			
2"			
2 1/2"			
3"			
4"			
5"			
6"			
8"			



Manufacturers and Distributors of Irrigation and Industrial Equipment
 6983 Supply Way • Boise, Idaho 83716
 (208) 345-2525 / Toll Free 1-800-635-5975
 FAX 1-208-345-2143
 www.clemonssales.net
 e-mail purchasing@clemonssales.net

TANK DOMES – VICTAULIC FITTINGS

Weld-On TANK DOME HEADS or PIPE ENDS

Steel

No. 4010-S

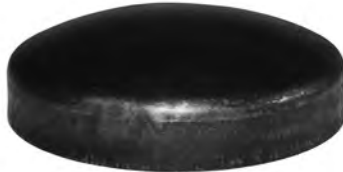

STANDARD

No. 4010-E



SEMI ELLIPTICAL

Also – Larger & Heavier

SIZE	GA.	WEIGHT	SEMI ELLIP.	GA.	WEIGHT	STANDARD
6	10	2.5		10	1.5	
8	10	4.0		10	3.0	
10	10	6.0		10	5.0	
12	10	8.5		10	6.0	
12	1/4	18.0		–	–	
14	1/4	26.0		10	7.8	
16	1/4	29.0		10	10	
18	1/4	32.0		10	13.0	
20	1/4	39.0		10	16.0	
22	1/4	47.0		10	20.0	
24	1/4	56.0		10	24.0	
26	1/4	66.0		10	28.0	
30	1/4	86.0		10	39.0	
36	1/4	118.0		10	46.0	

Standard Wall Dome pricing available.

Groove X Plain End

No. 4060



SIZE	OAL	WEIGHT
3"	4"	2.0
4"	4"	2.8
5"	3"	3.8
6"	4"	4.8
8"	4"	7.3
10"	4"	10.3
12"	4"	13.5

Gruvlok Coupling – 300P.S.I. Rated

No. 7000-C



No. 7000-G

**Complete Coupler
SIZE**

3"
4"
5"
6"
8"
10"
12"

Gasket Only

SIZE

3"
4"
5"
6"
8"
10"
12"

Manufacturers and Distributors of Irrigation and Industrial Equipment
 6983 Supply Way • Boise, Idaho 83716
 (208) 345-2525 / Toll Free 1-800-635-5975
 FAX 1-208-345-2143
www.clemonssales.net
 e-mail purchasing@clemonssales.net



SADDLES – VALVE TOPS



Saddle with Female Thread No. 4020

Epoxy Coated

Parts

- Single Bolt Pac
- 5" and 6" Saddle Gasket
- 8" thru 15" Saddle Gasket

SIZE	WEIGHT	3" THREAD	WEIGHT	4" THREAD
5	11.3		11	
6	12.7		12.5	
8	15		14.5	
10	17		17	
12	18		18	
15	23		23	

The above fittings are for use with PVC Plastic Pipe (IPS and PIP sizes), Standard Pipe, Steel and Aluminum Tubing, and some Transite Pipe Sizes.

HOLE SAWS – On 5" & 6" Saddles – Use 3 3/4" Hole Saw
On 8" thru 15" Saddles with 3" & 4" Outlets – Use 4" Hole Saw

– Call Us For Parts, Different Coatings, Saddles With Risers –



Weld On Valve – Galvanized No. 2090

SIZE	WEIGHT
3" x 6"	3
4" x 6"	3.75
6" x 6"	8.5
8" x 6"	15.5



Valve with Female Thread – Galvanized No. 2091

VALVE SIZE	THREAD SIZE	WEIGHT
3" x	3"	5
4" x	3"	5.75
4" x	4"	6
6" x	6"	21
8" x	8"	29.5



Valve with Female Thread – Aluminum No. 2092

VALVE SIZE	THREAD SIZE	WEIGHT
4" x	3"	4.5
4" x	4"	4.5



Manufacturers and Distributors of Irrigation and Industrial Equipment
6983 Supply Way • Boise, Idaho 83716
(208) 345-2525 / Toll Free 1-800-635-5975
FAX 1-208-345-2143
www.clemonssales.net
e-mail purchasing@clemonssales.net

Made In USA
FLANGED STEEL FITTINGS



Flanged 45° Black Elbow

No. 2150-F

SIZE	WEIGHT	12 GA	10 GA
		4"	20
5"	21		
6"	27		
8"	38		
10"	45		
12"	64		
14"	83		
16"	108		



Flanged 90° Black Elbow

No. 2145-F

SIZE	WEIGHT	12 GA	10 GA
		4"	18
5"	25		
6"	35		
8"	46		
10"	57		
12"	72		
14"	94		
16"	119		



Flanged Black Tee

No. 2155-F

SIZE	WEIGHT	12 GA	10 GA
		4"	26
5"	34		
6"	40		
8"	56		
10"	71		
12"	99		
14"	128		
16"	163		



Flanged Black Spool

No. 2157-F 12" Long

SIZE	WEIGHT	12 GA	10 GA
		4"	21
5"	26		
6"	31		
8"	42		
10"	53		
12"	72		
14"	82		
16"	89		

Manufacturers and Distributors of Irrigation and Industrial Equipment
 6983 Supply Way • Boise, Idaho 83716
 (208) 345-2525 / Toll Free 1-800-635-5975
 FAX 1-208-345-2143
 www.clemonssales.net
 e-mail purchasing@clemonssales.net



STEEL PIPE

In Stock

No. 4050

SIZE O.D.	GAGE	WEIGHT/FOOT (LBS)	5' TO	10' TO	20' TO	40'
4"	12	4.5	9'	19'	39'	
5"	12	5.6				
6"	12	6.8				
6 5/8"	12	7.5				
8"	12	9.0				
8 5/8"	12	9.8				
10"	12	11.3				
10 3/4"	12	12.2				
12"	12	13.6				
12 3/4"	12	14.5				
14"	12	15.9				
6"	10	8.6				
6 5/8"	10	9.3				
8"	10	11.6				
8 5/8"	10	12.5				
10"	10	14.5				
10 3/4"	10	15.6				
12"	10	17.5				
12 3/4"	10	18.6				
14"	10	20.4				
16"	10	23.4				
18"	10	26.3				
20"	10	28.5				
24"	10	34.2				

CALL FOR PIPE

QUOTATIONS

PIPE COMES IN 40' LENGTHS

PIPE CUT CHARGES = PIPE O.D.

*Call for quantity pricing. LTL loads and full truckloads.

*12 Ga. – 10 Ga. – 3/16" wall – 1/4" wall. From 4" to 36". (Most Sizes In Stock)

*Schedule 40 Pipe 2" to 12"



Manufacturers and Distributors of Irrigation and Industrial Equipment
 6983 Supply Way • Boise, Idaho 83716
 (208) 345-2525 / Toll Free 1-800-635-5975
 FAX 1-208-345-2143
 www.clemonssales.net
 e-mail purchasing@clemonssales.net



CLEMONS PRESSURE FINE FILTERS

Operation and Maintenance

This cartridge filter is designed to filter all organic debris larger than the size of perforation ordered. The filter cartridge will collect considerable debris before it is necessary to clean it. Once a 5 pound differential between the inlet and outlet is reached, the filter must be cleaned. Please note that all of the Clemons Pressure Filters have a one pound loss with a clean screen cartridge.

When cleaning the filter there are different methods available. Standard flush out from the factory is a 1"-4" male threaded nipple depending upon model size. Optional flush outlets are available up to 12" threaded or flanged. Larger flush outlets are necessary where certain types of debris, especially moss, are hard to flush out and require greater flushing volume to remove them. It is necessary from time to time, depending on the type of debris being removed, to remove the cartridge from the filter housing and clean it. Often times seeds will get lodged in the perforated holes and cannot be flushed out. We recommend a hose or brush to remove particles lodged in the screen. Please do not try to knock them loose because of possible damage to the screen. Brushes with handles are available to clean the inside of the screens for filter models 700, 1200, and 2000 on catalog page 13.

Since this filter does catch all the debris larger than the size of its perforation, cleaning it cannot be ignored. If the filter is allowed to plug solid the water has nowhere to go, therefore something must give and that means the screen cartridge will split.

If a system has excessively dirty water it may be necessary to install additional filters to allow for longer periods between cleaning.

Automatic purge valves are available; please contact your dealer.

Manufacturers and Distributors of Irrigation and Industrial Equipment
6983 Supply Way • Boise, Idaho 83716
(208) 345-2525 / Toll Free 1-800-635-5975
FAX 1-208-345-2143
www.clemonssales.net
e-mail purchasing@clemonssales.net





Installation and Operating Instructions for Clearwater and Sturgeon Self-Cleaning Suction Screens

1. Before installing CW Screen, check pumping system's pressure. If pumping with very low pressure, a booster pump may be required. Booster pump not supplied by Clemons. Consult specifications in CW brochure for recommended operation pressure. Higher pressure may be required for certain applications. Consult our factory.
2. Do not install backwash line smaller than 1/2" on CW 100 and 1-1/2" on CW 200 and larger. If your CW Screen will be located more than 100 feet from the pump a somewhat larger line may be necessary to overcome friction loss.
3. Check your CW specifications to be sure you don't exceed CW's maximum flow range. It may be less with some applications with excessive debris. For fisheries see the fish screen max GPM chart catalog page 15 for CW models.
4. Thoroughly flush the backwash line before attaching it to your CW screen. Failure to do this could result in plugging spray jets inside the screen.
5. Your CW Screen should not be located any closer than 6 inches to any object.
6. Install your CW Screen's flanged outlet to pump's suction/inlet pipe. If other adapter is desired instead of flange, please contact the factory. Plumb the backwash line into your pump's discharge pipe. It is not recommended to use the threaded plug holes in the pump case because there may not be enough pressure or water volume to operate screen.
7. Backwash line should be plumbed ahead of the main line's butterfly valve. The butterfly can be partially closed to create sufficient back pressure during start-up.
8. These items are to be installed on the backwash line (starting from the pump discharge to the CW screen) in the following order: One properly sized gate or ball valve (at least 1-1/2" or larger). One inline 18 mesh strainer (at least 1-1/2" or larger) and one pressure gauge (liquid filled recommended)
9. If necessary, access to internal parts of your CW Screen is very simple. Three bolts remove the entire screened area for complete access to internal parts. Special access plate upon request.
10. Your CW Screen does not need more than 7 inches of submergence because the self-cleaning action breaks up any vortex that might form

11. Your CW Screen with internal rotation spray bars lets you avoid complicated set-ups. Your CW Screen is rugged steel galvanized or epoxy coated body with heavy gauge stainless steel mesh screen. The CW Screen is versatile and affordable for self cleaning pump suction applications.
12. Some extreme applications conditions could be too harsh for the Clearwater screens to work properly. In extreme moss or dairy applications consult the factory.

Model	Flow U.S. GPM		Fish Screen Max GP For .4ft/ Sec		Screen Length	Total Length	Diameter	Flange Size	Return Inlet	Operate. Pressure	Weight Lbs.	GPM Used To Operate	Wide Wand GPM Used To Operate
	12/18m	24M	180	24M								12	20
CW100	200	165	180	9"	19.5"	12"	3"	1/2"	40-60	30	12	-	
CW200	325	225	355	11"	25"	16"	4"	1-1/2"	40-65	58	20	-	
CW400	550	400	485	15"	28.8"	16"	6"	1-1/2"	40-65	62	20	-	
CW600	750	525	775	16"	32.5"	24"	8"	1-1/2"	40-65	102	20	28	
CW800	950	700	875	18"	34.5"	24"	10"	1-1/2"	40-65	115	20	28	
CW1000	1350	950	1115	23"	39.5"	24"	10"	1-1/2"	40-65	123	28	36	
CW1400	1550	1075	1265	26"	42.5"	24"	12"	1-1/2"	40-65	131	28	36	
CW1700	1800	1250	1475	28"	44.5"	26"	12"	1-1/2"	40-65	148	28	36	
CW2000	2100	1450	1685	32"	48.5"	26"	14"	1-1/2"	40-65	160	36	44	
CW2400	2600	1800	2125	35"	52.5"	30"	16"	1-1/2"	40-65	223	36	44	
CW3000	3000	2075	2430	40"	57.5"	30"	16"	1-1/2"	40-65	236	44	52	
CW3500	3500	2420	2750	40"	59.5"	36"	18"	1-1/2"	40-65	283	44	52	
CW4000	4000	2765	3150	40"	63.5"	42"	18"	1-1/2"	40-65	358	44	52	

Model	Flow M3/Hour		Screen Length MM	Total Length MM	Diameter MM	Flange Size MM	Return Inlet MM	Min. Operate. Pressure Bars	Weight KG	Flow M3/Hour Used To Operate
	12/18m	24M								2.7
CW100	45	37	228	495	305	76	13	2.8	14	2.7
CW200	74	51	279	635	406	102	38	2.8	27	4.5
CW400	125	91	381	732	406	152	38	2.8	29	4.5
CW600	170	120	406	826	609	203	38	2.8	47	4.5
CW800	216	160	457	876	609	254	38	2.8	53	4.5
CW1000	307	216	584	1003	609	254	38	2.8	56	6.4
CW1400	352	247	660	1080	609	305	38	2.8	60	6.4
CW1700	409	288	711	1130	660	305	38	2.8	68	6.4
CW2000	477	336	813	1232	660	356	38	2.8	73	8.2
CW2400	591	409	889	1134	762	406	38	2.8	102	8.2
CW3000	682	480	1016	1461	762	406	38	2.8	105	10.0
CW3500	795	550	1016	1511	915	457	38	2.8	127	10.0
CW4000	909	628	1016	1613	1067	457	38	2.8	160	10.0

Manufacturers and Distributors of Irrigation and Industrial Equipment
 6983 Supply Way • Boise, Idaho 83716
 (208) 345-2525 / Toll Free 1-800-635-5975
 FAX 1-208-345-2143
 www.clemonssales.net
 e-mail purchasing@clemonssales.net



How to Select the Right Separator

The Clemons Separator is for all types of irrigation, industrial and agricultural systems – low or high pressure – and offers one to meet every individual's needs. To select the proper model, first identify the specific problem. This involves deciding where the separator will be used.

Next, confirm the minimum and maximum gallonage to be handled and the operating pressure to allow the unit to perform most efficiently. Figure the speed of inlet water to the separator of 3 1/2 feet per second minimum. Clemons offers separators to handle flows ranging from 5 to 7,800 U.S. GPMs, and can handle operating pressures up to 175 pounds. For standard models R5V through R40V and standard models R40LA through R120LA. Standard models R140LA through R180LA are rated at 150P.S.I.

Lastly, determine the amount of solids to be dumped and the desired purging technique – by hand or automated. The collection chamber should not be more than half full. An automatic purge valve should be used with all separators. Separated particles must be removed on a regular basis to prevent the separator from becoming “sand bound” (see “Accessories” for options).

The Clemons Separator is the best solution for your clogging problems. Its superior, heavy construction makes it the best choice, whatever your application. Best of all, since it has no moving parts, screens, filter media or backwash, the device is trouble-free, making it worry free.

Installation

All Clemons Separators are designed for easy installation. Large units have self-supporting legs with slots for anchor bolts and inlet piping can be for either clockwise or for counter-clockwise rotation. The units are shipped on skids or completely assembled. Large units are assembled as follows:

- A concrete foundation 12 inches square by a length 8 inches longer than the channel leg base should be placed under each leg with anchor bolts inserted in the concrete and some reinforcing steel. A lifting eye is supplied to assist in placing the separator body.

- Install pressure gauges on the 1/4 inch fittings.

- A 1/2 inch outlet is on the discharge pipe of the separator — this is to supply clean water down to the electric valve diaphragms where the sand is blown off.

- In and out piping to the separator should have a straight run of at least 5 pipe diameters in order to quiet the water down or straightening veins if less than 5 pipe diameters.

- DO NOT use thin wall elbows – these set up a vibration in the separator use smooth radius elbows. Check valves should be placed ahead of the separator. A vacuum relief valve should be placed up-stream from the separator. An automatic flush valve should be placed on the sand blow-off connection. These are inexpensive and are available in various types.

Small separators can be wall mounted, hung on the main piping, or placed on legs if ordered that way. Installation for both small and large units can be achieved by the following:

- Connect separator discharge to clean liquid pipeline using short nipples and union — same size as the separator discharge coupler.

- Install nipple and purge valve — same size as purge coupler.

- Using the bell reducer, supplied with the vertical separator, connect the separator inlet to the pipe carrying solid-laden liquid.



Manufacturers and Distributors of Irrigation and Industrial Equipment
6983 Supply Way • Boise, Idaho 83716
(208) 345-2525 / Toll Free 1-800-635-5975
FAX 1-208-345-2143
www.clemonssales.net
e-mail purchasing@clemonssales.net

Vertical In-Line Separator

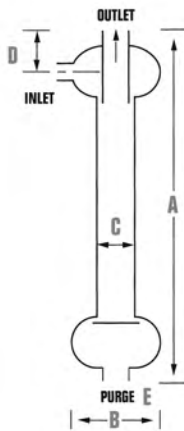
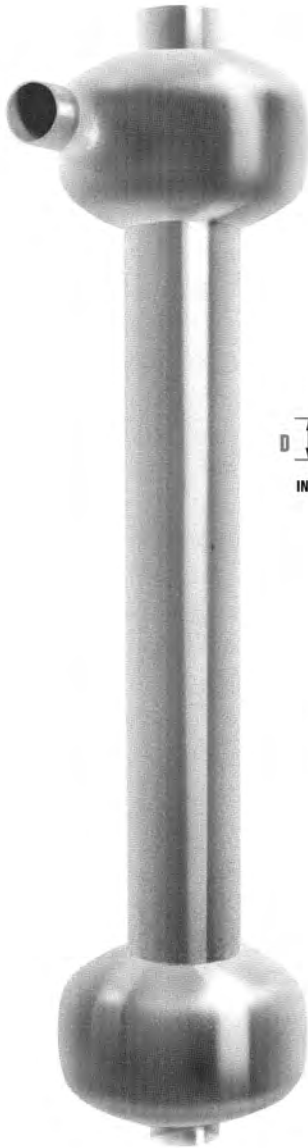

Model	GPM	Flow M3/Hr	Size	Length	[Lbs.]
R5V	4-10	.9-2.3	1/2"	21 1/2"	13
R7V	10-20	2.3-4.6	3/4"	21 1/2"	15
R10V	18-38	4-8.7	1"	30 1/2"	26
R12V	26-52	6-12	1 1/4"	30 1/2"	26
R15V	38-79	8.7-18	1 1/2"	30 1/2"	26
R20V	63-120	14.5-27.6	2"	38"	44
R25V	100-180	23-41.4	2 1/2"	44"	55
R30V	125-260	28.8-59.8	3"	48"	75
R40V	190-345	43.7-79.4	4"	49"	120

Dimensions

Inlet / Outlet	1/2"	3/4"	1"	1 1/4"	1 1/2"	2"	2 1/2"	3"	4"
A	21 1/2"	21 1/2"	30 1/2"	30 1/2"	30 1/2"	38"	44"	48"	49"
B	6"	6"	6"	6"	6"	8"	10"	10"	12"
C	2 3/8"	2 3/8"	3 3/8"	3 3/8"	3 3/8"	4 1/2"	4 1/2"	5 1/2"	6 5/8"
D	2 1/2"	2 1/2"	2 1/2"	2 3/4"	2 3/4"	3 1/4"	4 1/2"	4 7/8"	6 1/2"
E	1"	1"	1"	1"	1"	2"	2"	2"	2"

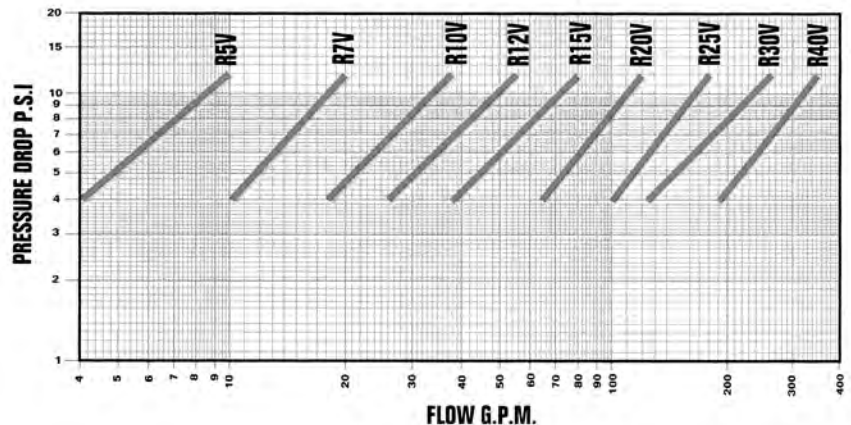

Normal Use: Between pump and system above ground.

Protects: Equipment between 5 and 345 GPM.

Ideal: For domestic house lines, sprinkler systems and industrial equipment.

Pressure Drop: See curves for proper size

Larger Pipes or Volumes: See Clemons Ag Separator Section.

Backwash Time and Waste: Install Clemons Separator ahead of sand filter for reductions.

Minimum Fine Sand Passage: Where this is not acceptable, use a Clemons Separator ahead of a fine filter.

Automatic Sand Blowoff: Excellent systems are available when desired (see "Accessories").

Modifications: Can be made for low operating pressures.

Installation: Mount upright. Place gate valve or hose bibb on blowoff at bottom of separator. Release sand often enough to keep sand build-up at minimum. Intermittent operation will permit some fines to pass through separator.

Ag and Industrial Separators

Capacity: 200 to 7,800 GPM.

Pressure Rating: 150 lb. standard for long life.

For higher ratings, contact factory

Flow into Separator: Standard counter-clockwise facing outlet. Clockwise rotation is available.

Sand Removal Efficiency: 98% of solids down to 200 mesh.

Pressure Drop: See curves for proper size.

Automatic Purge System: Available at low cost.

Strong: 1/4" carbon steel construction.

Model	GPM	Flow M3/Hr	Size	Shipping Length	[Lbs.]
R40LA	200-400	46-92	4"	87"	280
R60LA LF	365-700	84-161	6"	115 1/2"	493
R60LA HF	500-950	115-219	6"	115 1/2"	493
R80LA	800-1600	184-369	8"	124 3/4"	722
R100LA	1300-2300	299-529	10"	135"	840
R120LA	2025-3400	465-782	12"	156"	1400
R140LA	2975-5000	684-1150	14"	167"	2000
R160LA	4000-6200	920-1426	16"	182"	2310
R180LA	5000-7800	1150-1794	18"	192"	2750

Dimensions

Inlet / Outlet	4"	LF6"	HF6"	8"	10"	12"	14"	16"	18"
A	48 1/2"	63"	63"	71"	78"	102"	102 1/2"	108"	118 1/2"
B	46 1/2"	59 1/2"	59 1/2"	65"	71"	75 1/4"	85 3/8"	89 1/4"	98 1/4"
C	46 1/2"	60 3/8"	58 3/4"	66"	72 3/4"	76 1/2"	86 5/8"	90"	100 1/4"
D	16"	20 1/2"	20 1/2"	21 3/4"	21"	23 3/4"	24 1/2"	24 3/8"	27"
E	19"	20 3/4"	20 3/4"	22 5/8"	24 1/2"	26 5/8"	27 3/4"	29"	33 5/8"
F	7 1/2"	10 1/2"	10 1/2"	12"	13"	14 1/4"	12"	12"	15"
G	19"	22"	22"	24 1/2"	29"	32"	33 1/2"	33 1/2"	34 1/2"
H	4"	5 3/4"	5 1/4"	5 5/8"	7"	8 1/8"	9"	9"	11"
J	6 5/8"	10 3/4"	10 3/4"	12 3/4"	16"	18"	20"	24"	28"
K	12"	16"	16"	18"	22"	26"	28"	30"	36"
L	80"	106 1/4"	106 1/4"	114"	123 1/2"	139"	152 1/2"	160"	177"
M	1/4"	1/4"	1/4"	1/4"	1/4"	1/4"	1/4"	1/4"	1/4"
N	5"	5"	5"	5"	5"	5"	6"	6"	6"
P	1"	1"	1"	1"	1"	1"	1"	1"	1"
X	22"	30"	30"	34"	42"	50"	50"	54"	57 3/4"
Y	14"	14"	14"	16"	20"	24"	26"	28"	29 3/4"

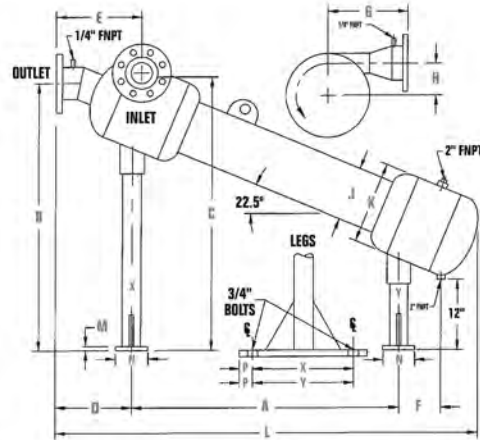

Flow and Pressure Drop Chart

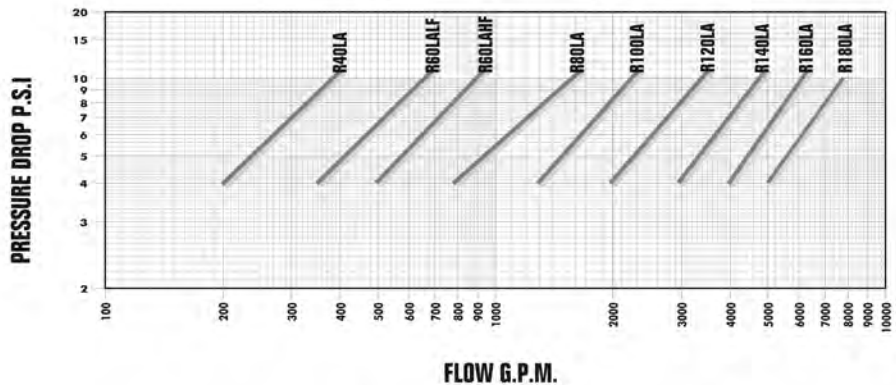

WARRANTY – DISCLAIMER

Clemons Sales Corp. warrants its goods only as follows:

GENERAL PROVISIONS

Clemons warrants that products manufactured by Clemons are free from defects in material and workmanship for a period of one year from the date of shipment from the factory.

Clemons' obligation under this warranty is limited to repairing or, at its option, replacing any part returned, transportation prepaid, to our factory, which in our judgement proved defective within twelve (12) months of sale by Clemons.

No warranty shall apply to (1) normal maintenance service or adjustments, (2) any goods which shall have been repaired or altered in any way so as, in our judgement, to affect adversely their stability or reliability, nor which have been subject to misuse, negligence, accident, poor assembly or improper installation.

To make this warranty effective, any warranty claim must be completed and filed with Clemons within thirty (30) days after date of failure and the parts claimed to be defective must be returned, freight prepaid, within ninety (90) days after date of failure.

LIMITATIONS

This Clemons warranty is expressly in lieu of any other warranties, expressed or implied, including without limitation, warranties of MERCHANTABILITY AND FITNESS FOR A PARTICULAR PURPOSE, and any other obligation or liability including crop damage or loss of crops, property damage, or liability for incidental or consequential damages on the part of Clemons.

No statement, representation, agreement or understanding, oral or written, made by an agent, by an authorized dealer, a Clemons representative or employee which is not contained in this Warranty-Disclaimer will be recognized or enforceable or binding upon Clemons Sales Corp. Only a written statement signed by an officer of Clemons may modify this Warranty-Disclaimer.

Any action for breach of any Clemons warranty must be commenced within one (1) year after date on which such cause of action accrued.

PRESSURE RECOMMENDATIONS – DO NOT EXCEED

Filters	125 P.S.I.	High Pressure Filters Avail. For Pressures Exceeding 125 P.S.I.
Irrigation couplers	130 P.S.I.	
Epoxy coated steel fittings (IPS & PIP)	130 P.S.I.	
Separators (R5V – R40V & R40LA – R120LA)	175 P.S.I.	
Separators (R140LA – R180LA)	150 P.S.I.	

It is necessary to use correct fittings and assembly methods to provide safe and proper performance. If there is any doubt or question concerning the use of a coupler or fitting in a system design, our Engineering Department will provide necessary advice and assistance.

Manufacturers and Distributors of Irrigation and Industrial Equipment
6983 Supply Way • Boise, Idaho 83716
(208) 345-2525 / Toll Free 1-800-635-5975
FAX 1-208-345-2143
www.clemonssales.net
e-mail purchasing@clemonssales.net



Clemons Centrifugal Sand Separator Automatic Purge Valve

Does the Dirty Work For You



2" Threaded Valve with Selenoid 110 Volt

**SOLIDS PURGING
AUTOMATICALLY.
RELIABLE. SIMPLE.
EFFECTIVE.**



Purging of separated solids is important. Separators may be purged Manually, but we recommend an Automatic System, so the user takes no risk of not purging the system often enough, therefore eliminating problems.

PROGRAMMING IS SIMPLE

Set button T1 to any valve opening time – 15 minutes to 12 hours. Set button T2 to any time between 1 and 90 seconds, to determine the length of time the valve is to be open – usually 20 to 25 seconds.

The automatic purge system minimizes liquid loss and concentrates solids for easy handling. Saves money, time, and labor. It eliminates the possibility of the Separator becoming "sand bound" which condition nullifies the effectiveness of the Separator. The valve construction is ideal for typical solids and many mild abrasives. The solid state plug-in controller can be placed in the normal pump control box. Other purge methods are available.

NOTE:

Connect clean water from discharge side of Separator, to the electric valve diaphragm connection.

FEATURES

- Solid brass construction.
- Water-proof solenoid coil, guaranteed for the life of the valve.
- Coil can be rotated 360° and easily removed without removing solenoid operator.
- Slow closing. No water hammer, surge or noise.
- Brass drain cock for manual operation.
- Pressure rating 200 psi.
- Cross handle flow control standard on 1" through 3" sizes, optional on 3/4" size.
- Diaphragm of one-piece molded construction with integral O-ring seal reinforced with 600 lb. test fabric.
- Stainless Steel insert seat in solenoid chamber.



Operation

Application of voltage to the input of the timer initiates the OFF delay. Upon completion of the OFF delay, the relay energizes and the ON delay begins. Upon completion of the ON delay, the relay de-energizes and one cycle is completed. This OFF/ON cycling continues until voltage is removed from the input. The OFF/ON delay periods are independently adjustable.

Manufacturers and Distributors of Irrigation and Industrial Equipment
6983 Supply Way • Boise, Idaho 83716
(208) 345-2525 / 1-800-635-5975

WIRING - See Back Side

<u>Controller Model</u>	<u>Adjustable Operation Frequency Dial T1</u>	<u>Adjustable Valve-open Time Dial T2</u>	<u>1 Phase Voltage</u>
TDF 24 ALA 12H/100S	¼ to 12 hrs.	1 - 90 Sec.	24
TFDF 120 ALA 12H/100S	Same	Same	120
TDF 24 or 120 ALA 100	Same	Same	24 or 120

CONTROLLER BASE WIRING – TDF Models for 1 CONTROLLER AND 1 OR MORE VALVES

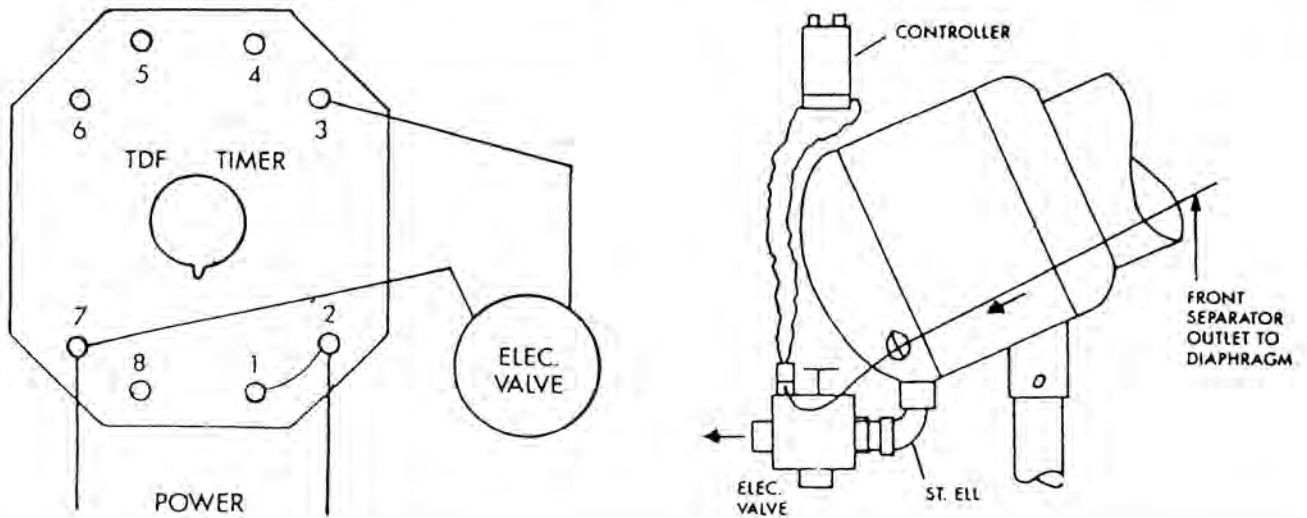

CONTROLLER BASE WIRING – for SEQUENCING BLOWING OR DUAL SEPARATORS

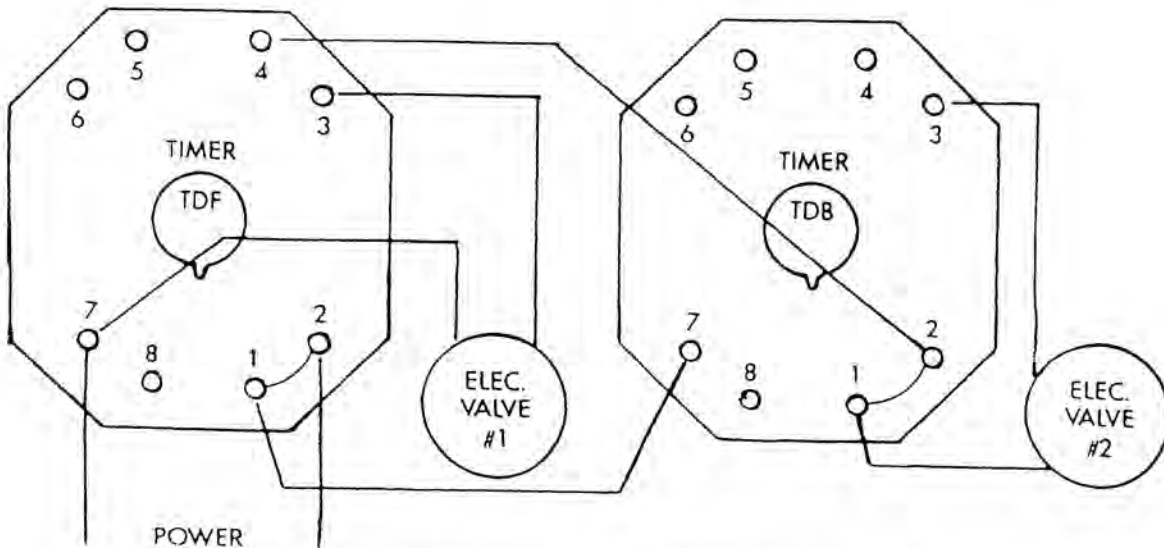

Manufacturers and Distributors of Irrigation and Industrial Equipment
 6983 Supply Way • Boise, Idaho 83716
 (208) 345-2525 / 1-800-635-5975

2018

January

Su	M	Tu	W	Th	F	Sa
	1	2	3	4	5	6
7	8	9	10	11	12	13
14	15	16	17	18	19	20
21	22	23	24	25	26	27
28	29	30	31			

February

Su	M	Tu	W	Th	F	Sa
				1	2	3
4	5	6	7	8	9	10
11	12	13	14	15	16	17
18	19	20	21	22	23	24
25	26	27	28			

March

Su	M	Tu	W	Th	F	Sa
				1	2	3
4	5	6	7	8	9	10
11	12	13	14	15	16	17
18	19	20	21	22	23	24
25	26	27	28	29	30	31

April

Su	M	Tu	W	Th	F	Sa
1	2	3	4	5	6	7
8	9	10	11	12	13	14
15	16	17	18	19	20	21
22	23	24	25	26	27	28
29	30					

May

Su	M	Tu	W	Th	F	Sa
		1	2	3	4	5
6	7	8	9	10	11	12
13	14	15	16	17	18	19
20	21	22	23	24	25	26
27	28	29	30	31		

June

Su	M	Tu	W	Th	F	Sa
					1	2
3	4	5	6	7	8	9
10	11	12	13	14	15	16
17	18	19	20	21	22	23
24	25	26	27	28	29	30

July

Su	M	Tu	W	Th	F	Sa
1	2	3	4	5	6	7
8	9	10	11	12	13	14
15	16	17	18	19	20	21
22	23	24	25	26	27	28
29	30	31				

August

Su	M	Tu	W	Th	F	Sa
			1	2	3	4
5	6	7	8	9	10	11
12	13	14	15	16	17	18
19	20	21	22	23	24	25
26	27	28	29	30	31	

September

Su	M	Tu	W	Th	F	Sa
						1
2	3	4	5	6	7	8
9	10	11	12	13	14	15
16	17	18	19	20	21	22
23	24	25	26	27	28	29
30						

October

Su	M	Tu	W	Th	F	Sa
	1	2	3	4	5	6
7	8	9	10	11	12	13
14	15	16	17	18	19	20
21	22	23	24	25	26	27
28	29	30	31			

November

Su	M	Tu	W	Th	F	Sa
				1	2	3
4	5	6	7	8	9	10
11	12	13	14	15	16	17
18	19	20	21	22	23	24
25	26	27	28	29	30	

December

Su	M	Tu	W	Th	F	Sa
						1
2	3	4	5	6	7	8
9	10	11	12	13	14	15
16	17	18	19	20	21	22
23	24	25	26	27	28	29
30	31					



Manufacturers and Distributors of Irrigation and Industrial Equipment

6983 Supply Way • Boise, Idaho 83716

(208) 345-2525 / Toll Free 1-800-635-5975

FAX 1-208-345-2143

www.clemonssales.net

e-mail purchasing@clemonssales.net

2018 CATALOG